

# CF0305P

cerniera per ante in vetro - hinge for glass door



materiale  
cerniera in metallo pressofuso  
guarnizioni in politene  
perno, molla e grani in acciaio  
bussola in nylon

material  
die-cast metal hinge  
polythene seals  
pin, spring and dowels made  
from steel  
nylon bush

finiture  
cromo lucido  
cromo satinato

finishings  
polished chrome  
satin finish chrome

CF0305P / A0  
CF0305P / G

Per vetro spessore mm 6  
For glass 6 mm thick  
Per vetro spessore mm 10  
For glass 10 mm thick

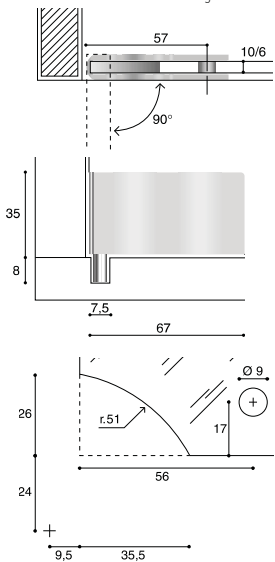

CF0305P / B0

Per vetro spessore mm 6  
For glass 6 mm thick

