

2 mandate e scrocco reversibile - catenacci in ottone
2 throws and reversible latch bolt - brass deadbolts

■ mm. 8

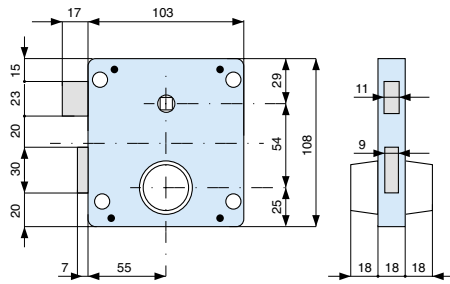

con cilindro
with cylinder

013.20.0



destra right
sinistra left

codice code

ENT

euro



433551 000
433552 000

2 50
2 50

2 mandate e scrocco reversibile - catenacci in ottone
2 throws and reversible latch bolt - brass deadbolts

■ mm. 8

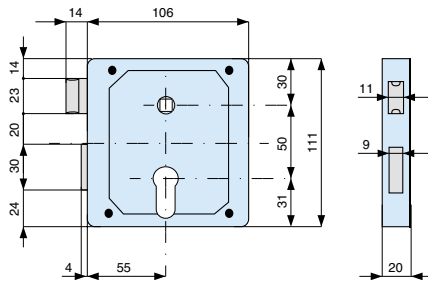

con cilindro
with cylinder

015.56.0



senza cilindro
without cylinder

codice code

ENT

euro



434550 000

2 50

434550 001

2 50

2 mandate e scrocco reversibile - catenacci in ottone
2 throws and reversible latch bolt - brass deadbolts

■ mm. 8

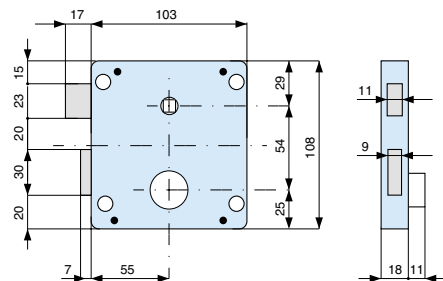

con cilindro
with cylinder

008.11.0



destra right
sinistra left

codice code

ENT

euro



435551 000
435552 000

2 50
2 50

2 mandate e scrocco reversibile - catenacci in ottone
2 throws and reversible latch bolt - brass deadbolts

■ mm. 8

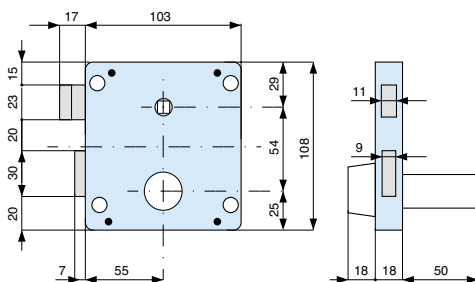

con cilindro
with cylinder

014.50.0

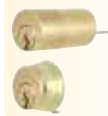

destra right
sinistra left

codice code

ENT

euro



436551 000
436552 000

2 48
2 48