

1 mandata e scrocco - catenaccio in ottone

Single throw and latch bolt - brass deadbolt

■ mm. 8

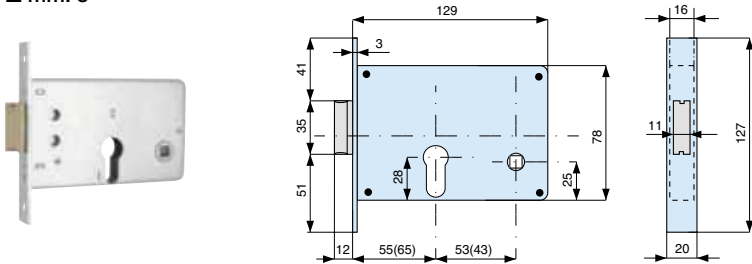

con cilindro
with cylinder

frontale
forend

codice code
ENT

euro



015.56.0



acciaio zincato
zinc plated steel

312550 000
312650 000

2 50
2 50

senza cilindro
without cylinder

acciaio zincato
zinc plated steel

312550 001
312650 001

2 50
2 50

1 mandata e scrocco - catenaccio in ottone

Single throw and latch bolt - brass deadbolt

■ mm. 8

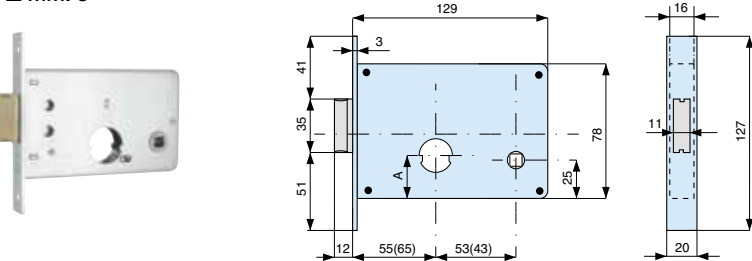

A

019.56.0	22,5
020.52.0	27

con cilindro
with cylinder

frontale
forend

codice code
ENT

euro



019.56.0



acciaio zincato
zinc plated steel

313550 000
313650 000

2 50
2 50

020.52.0



acciaio zincato
zinc plated steel

313552 000
313652 000

2 50
2 50

2 mandate e scrocco - catenaccio in ottone

2 throws and latch bolt - brass deadbolt

■ mm. 8

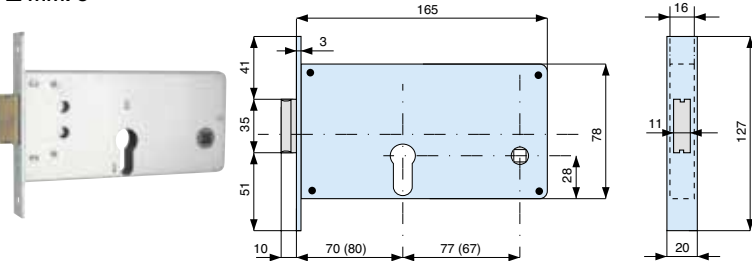

con cilindro
with cylinder

frontale
forend

codice code
ENT

euro



015.56.0



acciaio zincato
zinc plated steel

316700 000
316800 000

2 50
2 50

senza cilindro
without cylinder

acciaio zincato
zinc plated steel

316700 001
316800 001

2 50
2 50

2 mandate e scrocco - catenaccio in ottone

2 throws and latch bolt - brass deadbolt

■ mm. 8

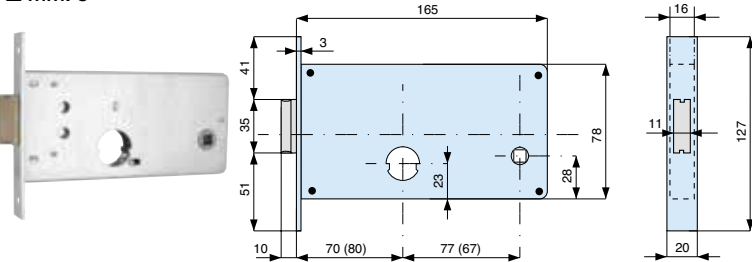

con cilindro
with cylinder

frontale
forend

codice code
ENT

euro



019.56.0



acciaio zincato
zinc plated steel

317700 000
317800 000

2 50
2 50