

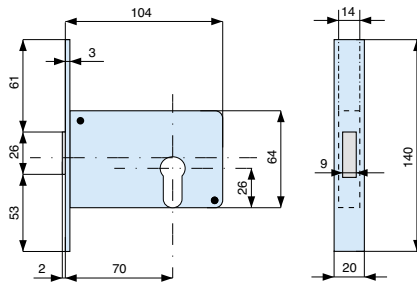

2 mandate - catenaccio in ottone
2 throws - brass deadbolt



con cilindro with cylinder	frontale forend	codice code ENT	euro
015.56.0			
	acciaio zincato zinc plated steel	282700 000	2 50
senza cilindro without cylinder	acciaio zincato zinc plated steel	282700 001	2 50

2 mandate e scrocco - catenaccio in ottone
2 throws and latch bolt - brass deadbolt

■ mm. 8

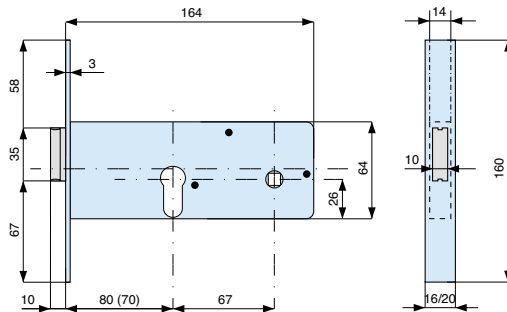



28370: 1 mandata e scrocco
1 throw and latch bolt

con cilindro with cylinder	frontale forend	codice code ENT	euro
015.56.0			
	acciaio zincato zinc plated steel	mm. 16 283701 000	2 50
		mm. 20 283702 000	2 50
		mm. 16 283801 000	2 50
		mm. 20 283802 000	2 50
senza cilindro without cylinder	acciaio zincato zinc plated steel	mm. 16 283701 001	2 50
		mm. 20 283702 001	2 50
		mm. 16 283801 001	2 50
		mm. 20 283802 001	2 50

1 mandata e scrocco - catenaccio in ottone
Single throw and latch bolt - brass deadbolt

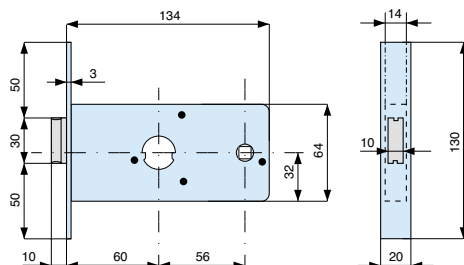
■ mm. 8



con cilindro with cylinder	frontale forend	codice code ENT	euro
019.56.0			
	acciaio zincato zinc plated steel	288600 000	2 50
020.52.0			
	acciaio zincato zinc plated steel	288602 000	2 50