

CILINDRI CYLINDER CORES

SERIE
26

26GCIL 26GCIL26G4

SERIE/SERIES

M1 M1M1

M2 M2M2

M4 M4M4

M6 M6 (*)M6 (*)

CIFRATURE/KEY CHANGES

M Chiavi differenti sotto chiave maestra *Keyed differently under master-key*

A KA chiavi uguali *KA keyed alike*

X Gruppi di KA *Groups of KA*

CHIAVI/KEYS

Standard *Standard*

S A snodo *Hinged*

FINITURA CILINDRO/CYLINDER FINISH

14 Nichelato *Nickel plated*

NE Nero *Black*



(*) Solo per articoli 2650 (*) *Only for 2650 item*

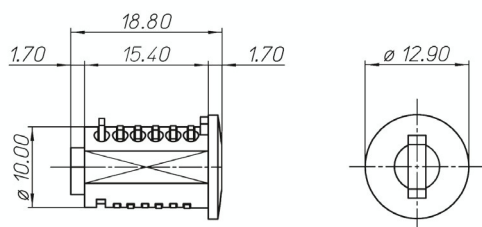

M6

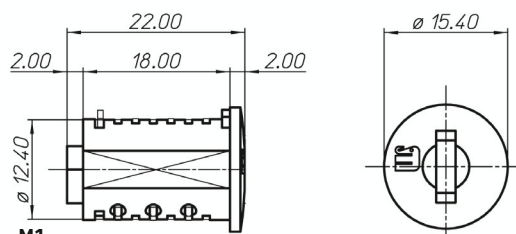

M1
M2
M4