

CILINDRO LUCCHETTABILE PADLOCKABLE CYLINDER

SERIE
26

26GPAD

LUCCHETTABILE

Zama + Plastica

14

FINITURE CORPO

Nichelato lucido

GR

FINITURE INSERTO

Grigio RAL 7011

CILINDRO

"L"

20

mm 20

25

mm 25

30

mm 30

LEVETTE vedi pag 22

Senza levetta

35

Piana A35

CONFEZIONI

100 pz

ⓘ

Adatto per lucchetti con archetto da Ø4 a Ø8 mm

Inserti in plastica personalizzabili con logo e colori a fronte di un lotto minimo da concordare

PAD-LOCK

Die cast + Plastica

BODY FINISHES

Nickel plated

INSERT FINISHES

Grey RAL 7011

CYLINDER

"L"

mm 20

mm 25

mm 30

CAMS see page 22

Without cam

Flat A35

PACKAGING

Boxed in 100's

Suitable for padlocks with shackle from Ø4 to Ø8 mm

Customized inserts (logo and colours) upon minimum quantity to be agreed



Immagine con / Picture with 2651

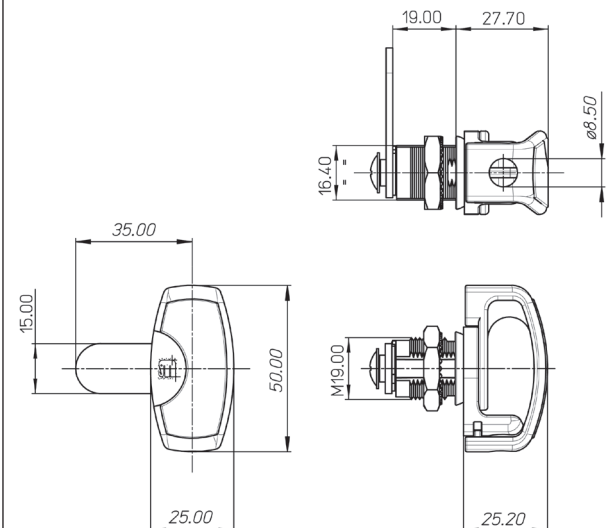
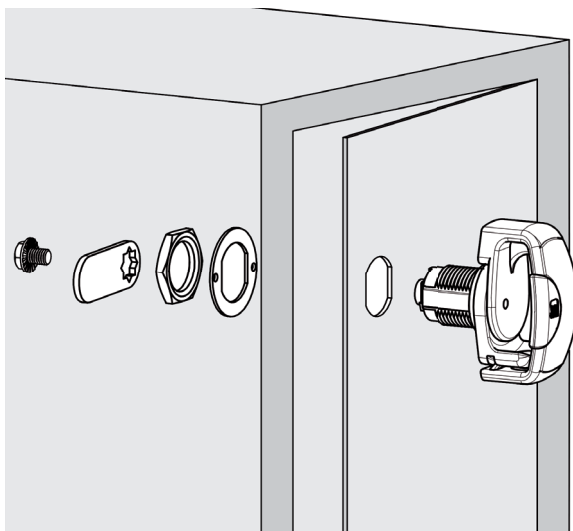
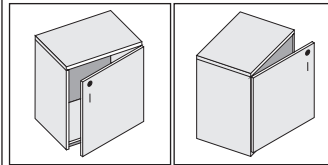

Schema di montaggio LUCCHETTABILE Assembling plan PADLOCKABLE

SERIE
26

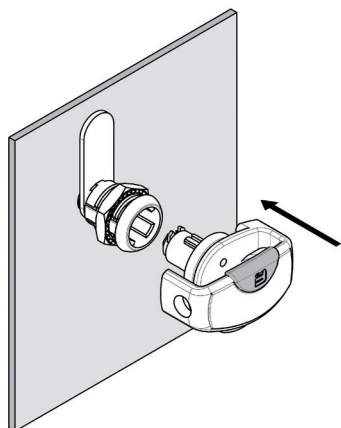

- 1** Inserire il lucchettabile con una leggera pressione e accertarsi dell'avvenuto aggancio
Insert padlockable with a slight pressure, making sure of the correct snap-in

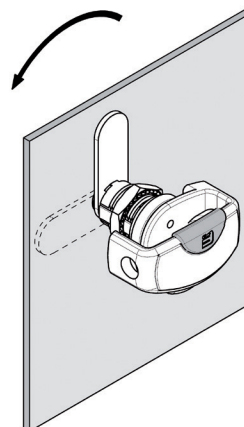

- 2** Ruotare in senso antiorario il lucchettabile di 90° per allineare i fori della parte fissa e della parte rotante
Rotate 90° anti-clockwise the padlockable to align the holes of both fixed and movable parts

Schema smontaggio LUCCHETTABILE Disassembling plan PADLOCKABLE

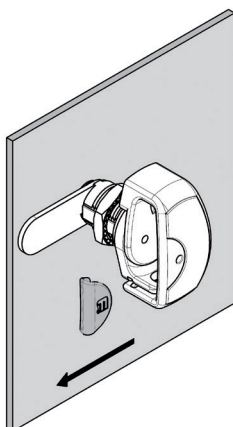

- 1** Rimuovere l'inserto laterale in plastica
Remove the side plastic insert

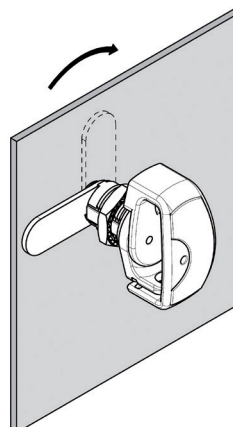

- 2** Ruotare in senso orario il lucchettabile di 90°
Rotate 90° clockwise the padlockable

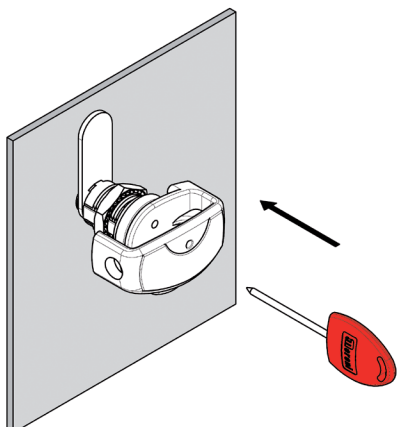

- 3** Inserire la chiave di sgancio
Insert the release key

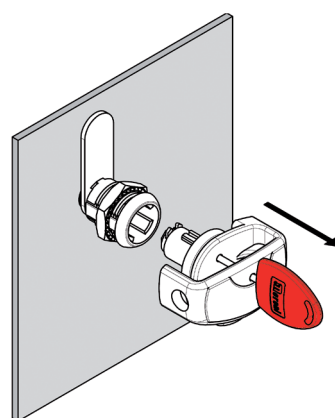

- 4** Estrarre il lucchettabile
Pull-out the padlockable