

3388 3388

FUNZIONAMENTO

Rotazione 90° (1 uscita chiave)

FINITURE

- US26 Cromo lucido
- NE Rivestito nero
- GO Rivestito giallo
- VE Rivestito verde
- BU Rivestito blu
- MA Rivestito magenta
- RO Rivestito rosso

STELO

Ø 12

LUCE

Peso di 1 pz

22 mm 22 g 318,20

36 mm 36 g 328,80

CIFRATURE

- KD Chiavi differenti (*)
- KA Chiavi uguali

CHIAVE

Art.1833 (3 pz)

CONFEZIONI

Blister in scatola da 10 pz
Industria 50 pz

(*) 250.000 combinazioni

TÜV

Omologato

OPERATION

Rotating 90° (1 key pull)

FINISHES

- Polished chrome
- Black plastic covered
- Yellow plastic covered
- Green plastic covered
- Blue plastic covered
- Magenta pink plastic covered
- Red plastic covered

BAS SIZE

Ø 12

BAR LENGTH

Weight of 1's

mm 22 ozs 11,22

mm 36 ozs 11,60

KEY-CHANGES

- Keyed differently (*)
- Keyed alike

KEY

Art.1833 (3 pcs)

PACKAGING

Individual blister into 10's box
Bulk in 50's

(*) 250.000 combinations

Approved

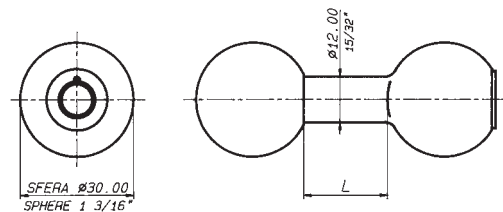
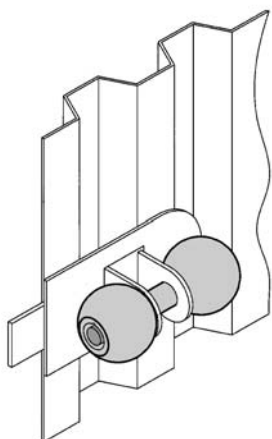

Luccotto cromato
Chromed "luccotto"

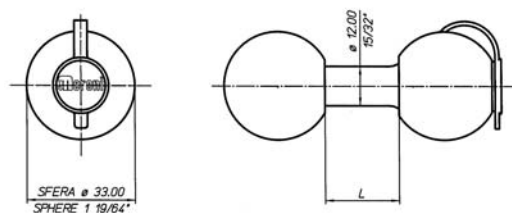

Luccotto rivestito con tappo antipolvere
Plastic covered "luccotto" with dust cover