

KALIPSO

- Kalipso è il reggipiano per la zona giorno, la zona notte e per la cucina.
- Caratterizzato dall'assenza di viti a vista.
- Previsto in diverse versioni: con foro vite, con vite euro preassemblata, con perno ($\varnothing 5$, $\varnothing 4$, $\varnothing 3$), con bussola e vite preassemblata.
- Montaggio e smontaggio manuali.
- Colori standard o personalizzabili su richiesta (previa verifica tecnica).
- Garantisce totale sicurezza grazie alla proprietà di antiganciamento.
- Peso supportato 25 Kg secondo norma UNI:EN 16337.
- Materiale: zama e plastica.

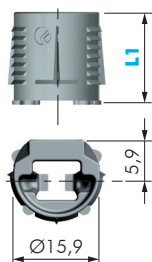

FORATURE

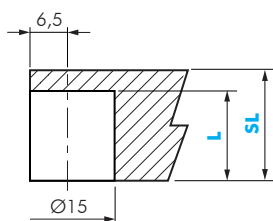

SL	DESCRIZIONE	L	L1
18/19	SUPPORTO KALIPSO	15,5	15
25		18,5	18
29/30		21	20,5

DIMENSIONI

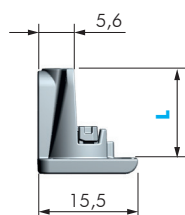
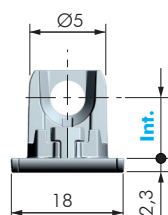

SL	DESCRIZIONE	INT	L
18/19	KALIPSO CON FORO	9,5	14
25		12,5	17
29/30		15	19

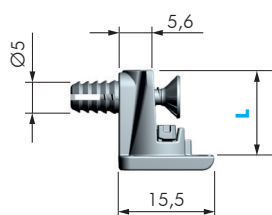
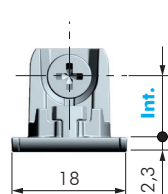

SL	DESCRIZIONE	INT	L
18/19	KALIPSO CON BUSSOLA E VITE PREMONTATA	9,5	14
25		12,5	17
29/30		15	19

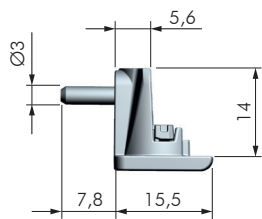
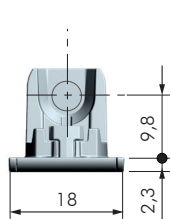

SL	DESCRIZIONE
18/19	KALIPSO CON PERNO

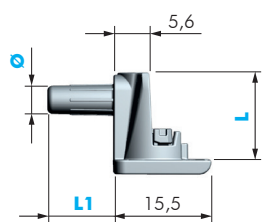
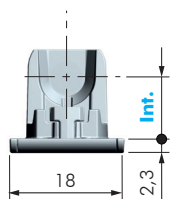

SL	DESCRIZIONE	INT	L	L1	Ø
18/19	KALIPSO CON PERNO	9,5	14	9	4
25		12,5	17	10,5	5
29/30		14,5	18,5		

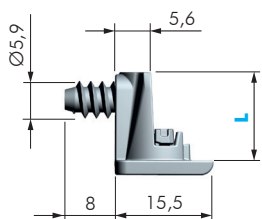
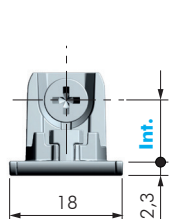

SL	DESCRIZIONE	INT	L
18/19	KALIPSO CON VITE EURO	9,5	14
25		12,5	17
29/30		15	19

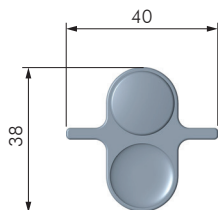

DESCRIZIONE
DIMA PER SUPPORTO KALIPSO SL 18÷19 - 25 - 29÷30

INSTALLAZIONE

STEP 1 - Inserimento reggipiano

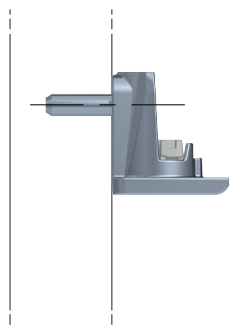

STEP 2 - Apertura cover

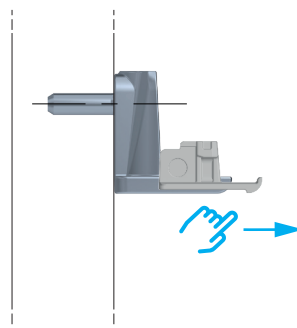

STEP 3 - Inserimento ripiano

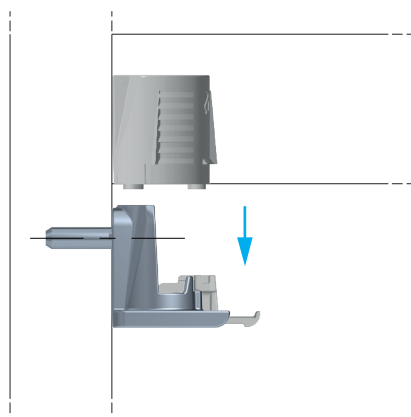

STEP 4 - Chiusura cover

