

# UNI-JET M20/12 – hinge-side accessories

## Stay-bearing

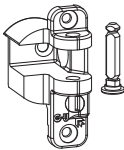

Stay-bearing M20			
Item	System	PU	Order number
52H	12/18+20-9	100	6-28020-00-L/R-1

- Compatible with hinge-side M20 – up to 130 kg sash weight
  - Can be used with 12 mm clearance, 18 or 20 mm overlap and 9 mm axis
  - Can be used in Euro-groove 7/8 x 4 and Euro-rebate 20 x 8
  - Drill hole for 1 x Ø 34 mm drill-hole part, milling depth 20 mm
  - Version with flush overlap
  - Includes stay-bearing pin
- Order number for spare part: 9-32915-00-0-1

# UNI-JET M20/12 – hinge-side accessories

## Stay-bearing

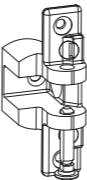

Stay-bearing M20, centred			
Item	System	PU	Order number
52J	12/18+20-9	100	6-28314-00-0-1

- Compatible with hinge-side M20 – up to 130 kg sash weight
  - Can be used with 12 mm clearance, 18 or 20 mm overlap and 9 mm axis
  - Can be used in Euro-groove 7/8 x 4 and Euro-rebate 20 x 8
  - Drill hole for 1 x Ø 34 mm drill-hole part, milling depth 20 mm
  - Centred version (used e.g. with arched stays)
  - Includes stay-bearing pin
- Order number for spare part: 9-32915-00-0-1

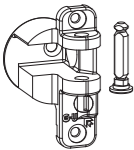

Stay-bearing M20			
Item	System	PU	Order number
52I	12/18+20-9	100	6-28020-18-L/R-1

- Compatible with hinge-side M20 – up to 130 kg sash weight
  - Can be used with 12 mm clearance, 18 or 20 mm overlap and 9 mm axis
  - Can be used in Euro-groove 18 x 8
  - Drill hole for 1 x Ø 34 mm drill-hole part, milling depth 20 mm
  - Version with flush overlap
  - Includes stay-bearing pin
- Order number for spare part: 9-32915-00-0-1

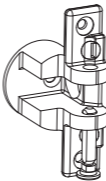

Stay-bearing M20, centred			
Item	System	PU	Order number
52K	12/18+20-9	100	6-28314-18-0-1

- Compatible with hinge-side M20 – up to 130 kg sash weight
  - Can be used with 12 mm clearance, 18 or 20 mm overlap and 9 mm axis
  - Can be used in Euro-groove 18 x 8
  - Drill hole for 1 x Ø 34 mm drill-hole part, milling depth 20 mm
  - Centred version (used e.g. with arched stays)
  - Includes stay-bearing pin
- Order number for spare part: 9-32915-00-0-1