

CERNIERE ANTA RIBALTA FUTURA 3D R

04721

Funzioni

Gruppo cerniere (superiore e inferiore) necessarie per la realizzazione di un infisso Anta Ribalta Futura 3D R.

Finiture

Verniciata nei colori RAL

Confezioni

Scatola da 10 pezzi

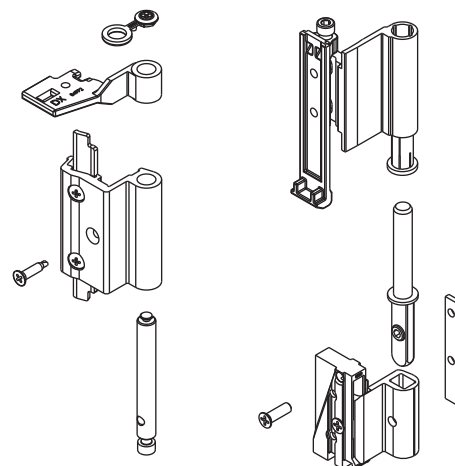

L'Anta Ribalta FUTURA 3D R è classificata per 110 Kg.

E' disponibile in due versioni, tradizionale **FUTURA 3D R** e logica **FUTURA 3D R lgc**.

Per le dimensioni minime e massime realizzabili e per il relativo vetro da utilizzare si faccia sempre riferimento alle tabelle riportate a fianco.



Tabella del massimo spessore del vetro realizzabile

2500	35	29	25	22	19	17	16	14	13	12	12	11	10	
2400	36	30	26	22	20	18	16	15	14	13	12	11	11	
2300	38	31	27	23	21	19	17	16	14	13	13	12	11	
2200	39	33	28	25	22	20	18	16	15	14	13	12	12	
2100	41	34	29	26	23	21	19	17	16	15	14	13	12	
2000	43	36	31	27	24	22	20	18	17	15	14	13	13	
1900	45	38	32	28	25	23	21	19	17	16	15	14	13	
1800	48	40	34	30	27	24	22	20	18	17	16	15	14	
1700	50	42	36	32	28	25	23	21	20	18	17	15	14	
1600	50	45	39	34	30	27	25	22	21	19	17	15	14	
1500	50	48	41	36	32	29	26	24	22	20	17	15	14	
1400	50	50	44	39	34	31	28	26	23	20	17	15	14	
1300	50	50	47	42	37	33	30	27	23	20	17	15		
1200	50	50	50	45	40	36	32	27	23	20	17			
1100	50	50	50	49	44	39	32	27	23	20				
1000	50	50	50	50	48	39	32	27	23					
900	50	50	50	50	48	39	32	27						
800	50	50	50	50	48	39	32							
700	50	50	50	50	48	39								
600	390	500	600	700	800	900	1000	1100	1200	1300	1400	1500	1600	1700

1	2	3	4	5	6	7	8	9
-	4	110	0	1	4	-	8	1300/1200

FUTURA 3D	FUTURA 3D
R	R lgc

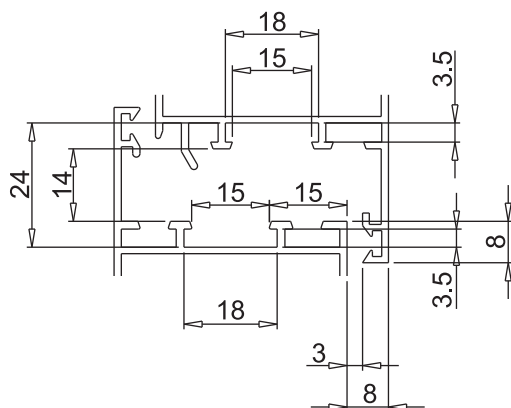
Meccanismo di chiusura per cremonese	04766000N	04768000N
Meccanismo di chiusura per martellina	04767000V	04768000 01062000
Cerniere	04721...	04722 ...
Braccio tipo 1	04229000	0422900
Braccio tipo 2	04230000	04230000
Cremonese	01033K Prima 01090K Euro	01193 Prima Key
Martellina	02484 Prima 02460 Master	02486 Prima Key

Tabella portata massima realizzabile

2500	110	110	110	110	110	110	110	110	110	110	110	110	110	
2400	110	110	110	110	110	110	110	110	110	110	110	110	110	
2300	110	110	110	110	110	110	110	110	110	110	110	110	110	
2200	110	110	110	110	110	110	110	110	110	110	110	110	110	
2100	110	110	110	110	110	110	110	110	110	110	110	110	110	
2000	110	110	110	110	110	110	110	110	110	110	110	110	110	
1900	110	110	110	110	110	110	110	110	110	110	110	110	110	
1800	110	110	110	110	110	110	110	110	110	110	110	110	106	
1700	110	110	110	110	110	110	110	110	110	110	110	106	100	
1600	110	110	110	110	110	110	110	110	110	110	107	100	94	
1500	110	110	110	110	110	110	110	110	110	110	100	94	88	
1400	110	110	110	110	110	110	110	110	108	100	83	88	82	
1300	110	110	110	110	110	110	110	108	100	93	87	81		
1200	110	110	110	110	110	110	108	100	92	86	80			
1100	110	110	110	110	110	100	92	85	79	73				
1000	110	110	110	110	100	91	83	77	72					
900	110	110	110	100	90	82	75	69						
800	110	110	100	89	80	73	67							
700	110	100	88	78	70	64								
600	390	500	600	700	800	900	1000	1100	1200	1300	1400	1500	1600	1700

FUTURA 3D

R

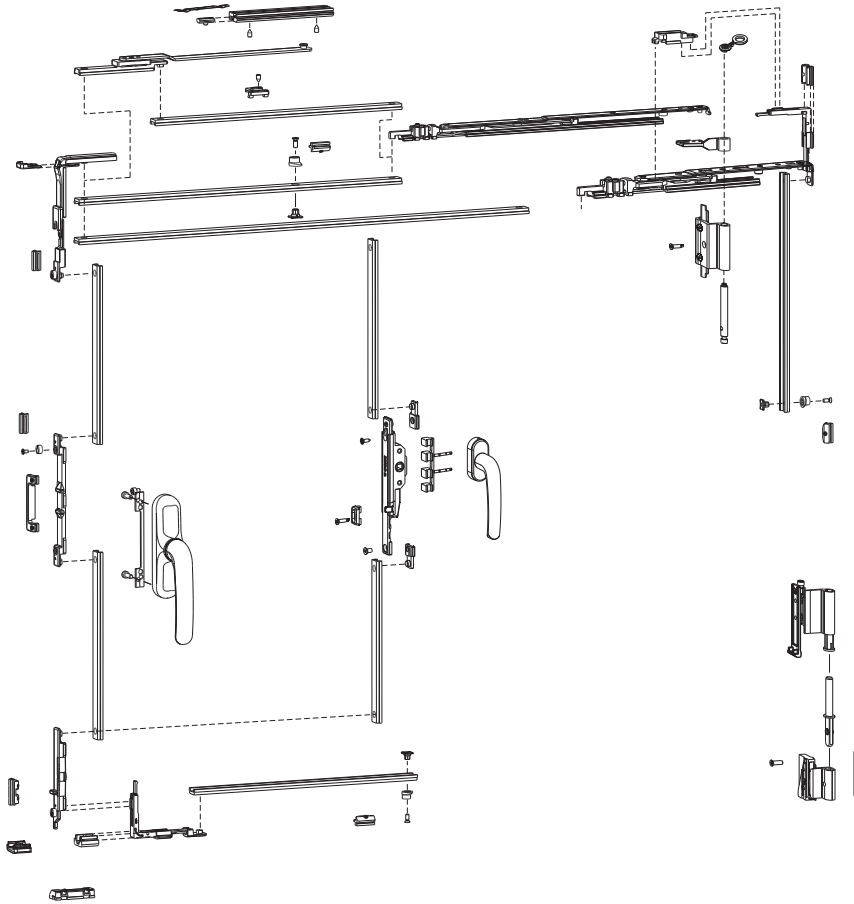

FUTURA 3D

R lgc

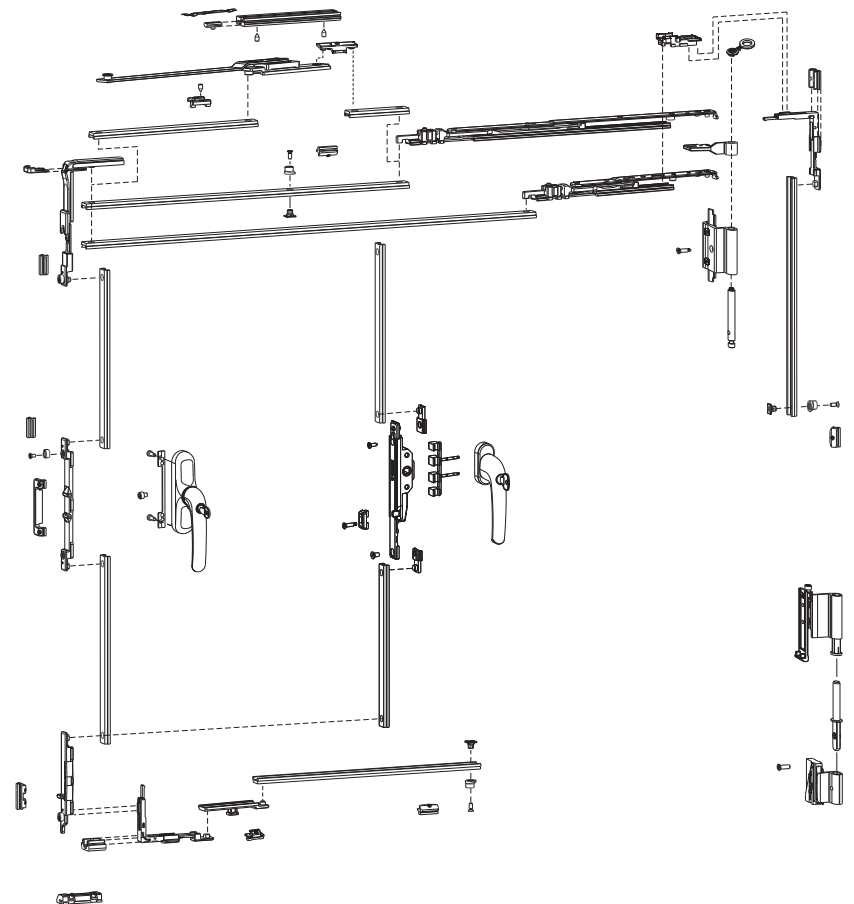

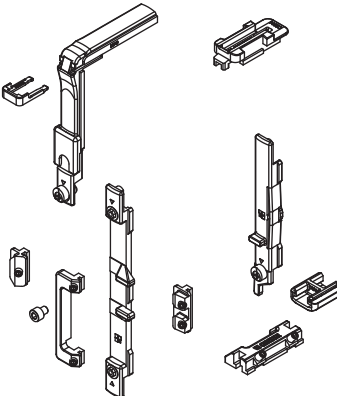
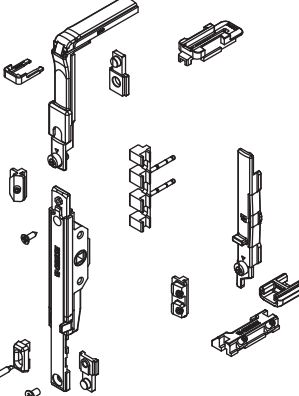
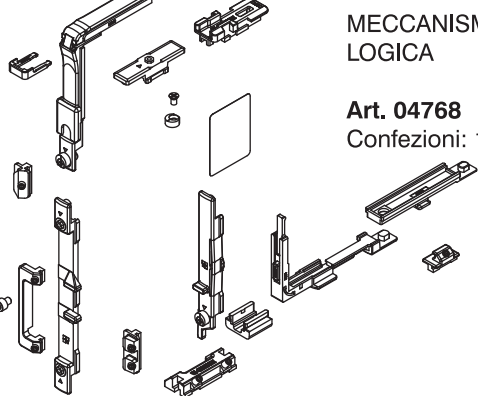
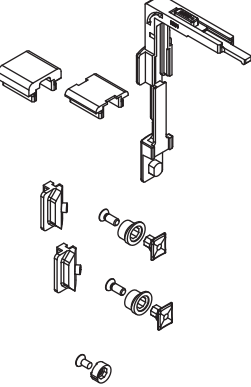
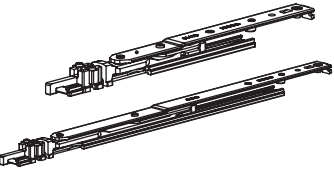
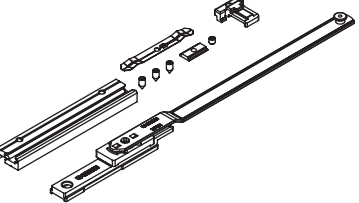
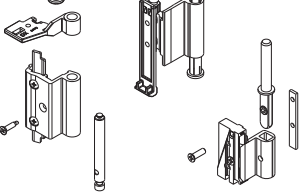
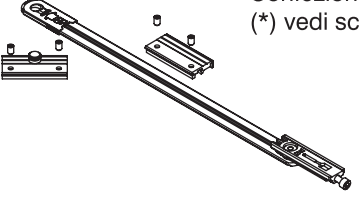
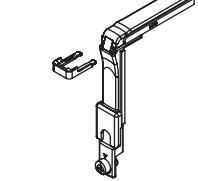
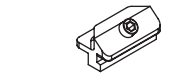
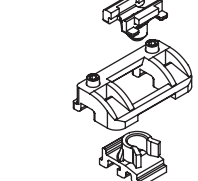
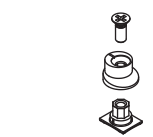
 <p>MECCANISMO CHIUSURA A/R Art. 04766 Confezioni: 10 pezzi</p>	 <p>MECCANISMO CHIUSURA A/R CON MOVIMENTAZIONE M180 Art. 04767 Confezioni: 10 pezzi</p>
 <p>MECCANISMO CHIUSURA A/R LOGICA Art. 04768 Confezioni: 10 pezzi</p>	 <p>CHIUSURE SUPPLEMENTARI Art. 04648K (H>1200 L>1000) Confezioni: 10 pezzi</p>
 <p>BRACCIO FUTURA 3D R e Rlgc Art. 04229 (T1 - L=390÷540) Art. 04230 (T2 - L=541÷1700) Confezioni: 10 pezzi</p>	 <p>BRACCIO SUPPLEMENTARE FUTURA R Art. 04308K (L>1000) Confezioni: 5 pezzi</p>
 <p>CERNIERE AR FUTURA 3D R Art. 04721 Confezioni: 10 pezzi</p>	 <p>BRACCIO LIMITATORE (*) Art. 02034K Confezioni: 10 pezzi (*) vedi scheda tecnica specifica</p>
 <p>RINVIO D'ANGOLO (*) Art. 04017K Confezioni: 10 pezzi (*) vedi scheda tecnica specifica</p>	 <p>ROSTRO DI CHIUSURA REGISTRABILE Art. 01391K Confezioni: 50 pezzi (*) vedi scheda tecnica specifica</p>
 <p>FERMA ANTA Art. 02198K Confezioni: 50 pezzi</p>	 <p>NOTTOLINO REGOLABILE Art. 04030K Confezioni: 200 pezzi</p>

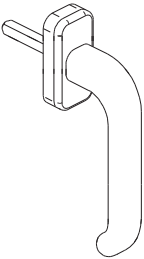
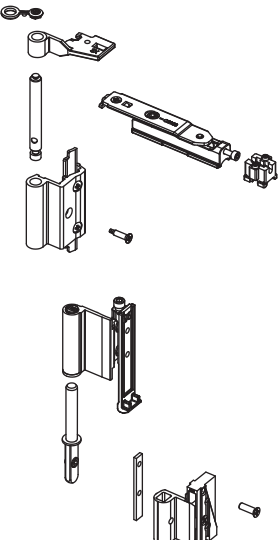
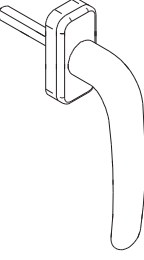
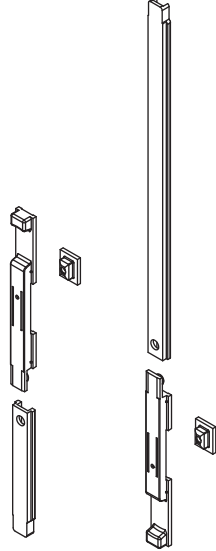
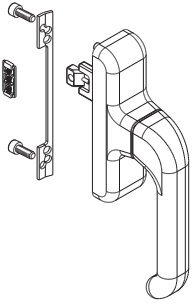
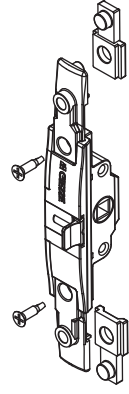
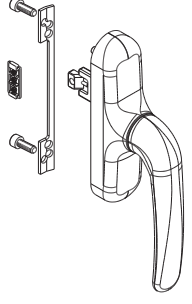
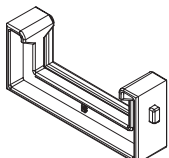
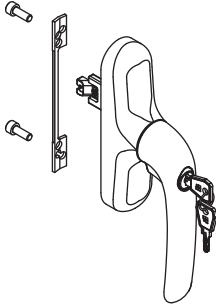
 <p>MARTELLINA MASTERMAR</p> <p>Art. 02460 Confezioni: 5 pezzi</p>	 <p>KIT CERNIERE ANTA ABBINATA FUTURA 3D R</p> <p>Art. 04722 Confezioni: 5 pezzi</p>
 <p>MARTELLINA PRIMA</p> <p>Art. 02484 Prima Confezioni: 10 pezzi</p> <p>Art. 02481 Prima in ottone Confezioni: 10 pezzi</p> <p>Art. 02486 Prima Key Igc Confezioni: 5 pezzi</p>	 <p>CATENACCIO GIAP ANTA ABBINATA AD ANTA RIBALTA H > 600</p> <p>Art. 04265K Confezioni: 10 pezzi</p>
 <p>CREMONESE EURO</p> <p>Art. 01090K Confezioni: 10 pezzi</p>	 <p>MOVIMENTAZIONE MONODIREZIONALE M180</p> <p>Art. 01062 Confezioni: 10 pezzi</p>
 <p>CREMONESE PRIMA</p> <p>Art. 01033K Prima Confezioni: 10 pezzi</p> <p>Art. 01135K Prima in ottone Confezioni: 5 pezzi</p>	 <p>DIMA</p> <p>Art. 06543 Confezioni: 10 pezzi</p>
 <p>CREMONESE PRIMA KEY CAPTURE</p> <p>Art. 01193 Confezioni: 5 pezzi</p>	