

91280

TC CEI

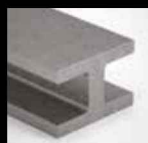





ALWAYS UP-TO-DATE WITH REGULATIONS



DIN 912 • Uni 5931 • Iso 4762



SCREWS HEXAGON SOCKET CYLINDER HEAD

-  Viti testa cilindrica esagono incassato
-  Zylinderkopf Schrauben mit Innensechskant
-  Vis tête cylindrique six pans creux
-  Tornillos cabeza cilíndrica hexágono interior
-  Винты цилиндрическая головка с внутренним шестигранником

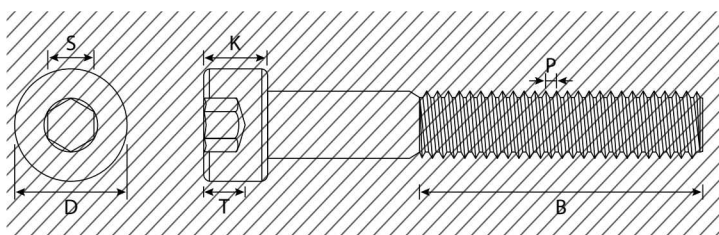

Diameters Diametri	Limits Limiti	D	K	T	S	B	P
M 4	Min.	6,78	3,82	2,00	3,02	~20,00	~0,70
	Max	7,22	4,00	-	3,08		
M 5	Min.	8,28	4,82	2,50	4,02	~22,00	~0,80
	Max	8,72	5,00	-	4,09		
M 6	Min.	9,78	5,70	3,00	5,02	~24,00	~1,00
	Max	10,22	6,00	-	5,14		
M 8	Min.	12,73	6,76	4,00	6,02	~28,00	~1,25
	Max	13,27	8,00	-	6,14		
M 10	Min.	15,73	9,64	5,00	8,02	~32,00	~1,50
	Max	16,27	10,00	-	8,17		

Diameters Diametri	Limits Limiti	D	K	T	S	B	P
M 12	Min.	17,73	11,57	6,00	10,02	~36,00	~1,75
	Max	18,27	12,00	-	10,17		
M 14	Min.	20,67	13,57	7,00	12,03	~40,00	~2,00
	Max	21,33	14,00	-	12,21		
M 16	Min.	23,67	15,57	8,00	14,03	~44,00	~2,00
	Max	24,33	16,00	-	14,21		
M 20	Min.	29,67	19,48	10,00	17,05	~52,00	~2,50
	Max	30,33	20,00	-	17,23		

CL. 8.8

- **High tensile Steel**
Acciaio ad alta resistenza
- **Class 8.8 steel**
Acciaio Classe 8.8
- **Tensile Strength: 800 N/mm²**
Resistenza alla rottura per trazione: 800 N/mm²
- **Elastic limit: 640 N/mm²**
Limite di elasticità: 640 N/mm²
- **Min. elongation: 12%**
Allungamento min: 12%

91280

TC CEI



- SIZES MISURE**
- M 4 x 6
 - 8
 - 10
 - 12
 - 14
 - 16
 - 18
 - 20
 - 25
 - 30
 - 35
 - 40
 - 45
 - 50
 - 55
 - 60

- M 5 x 8
- 10
- 12
- 14
- 16
- 18
- 20
- 25
- 30
- 35
- 40
- 45
- 50
- 55
- 60
- 65
- 70
- 75
- 80
- 85
- 90
- 100



- SIZES MISURE**
- M 6 x 10
 - 12
 - 14
 - 16
 - 18
 - 20
 - 25
 - 30
 - 35
 - 40
 - 45
 - 50
 - 55
 - 60
 - 65
 - 70
 - 75
 - 80
 - 85
 - 90
 - 100

- M 8 x 12
- 14
- 16
- 18
- 20
- 25
- 30
- 35
- 40
- 45
- 50
- 55
- 60
- 65
- 70
- 75
- 80
- 85
- 90
- 100
- 110
- 120
- 130
- 140
- 150



- BLIND RIVETS
- STAINLESS STEEL SCREWS
- HEX LAG SCREWS
- DRYWALL SCREWS
- CARPENTRY WOOD SCREWS
- CHIPBOARD SCREWS
- DOME & EURO SCREWS
- MACHINE SCREWS
- TRILOBULAR SCREWS NUTS BOLTS WASHERS THREADED RODS
- SELF-TAPPING SCREWS
- CONCRETE SCREWS
- BLOCKFRAME SCREWS
- SELF-DRILLING SCREWS
- BITS

91280

TC CEI



SCREWS HEXAGON SOCKET CYLINDER HEAD

- Viti testa cilindrica esagono incassato
- Zylinderkopf Schrauben mit Innensechskant
- Vis tête cylindrique six pans creux
- Tornillos cabeza cilíndrica hexágono interior
- Винты цилиндрическая головка с внутренним шестигранником

FINISHING	PACKAGING
-----------	-----------

SIZES
MISURE

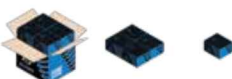

- M 10 x 20
- 25
- 30
- 35
- 40
- 45
- 50
- 55
- 60
- 65
- 70
- 75
- 80
- 85
- 90
- 100
- 110
- 120
- 130
- 140
- 150

- M 12 x 20
- 25
- 30
- 35
- 40
- 45
- 50
- 55
- 60
- 65
- 70
- 75
- 80
- 85
- 90
- 100
- 110
- 120
- 130
- 140
- 150

FINISHING	PACKAGING
-----------	-----------

SIZES
MISURE



- NEW M 14 x 30
- NEW 40
- NEW 50
- NEW 60
- NEW 70
- NEW 80
- NEW 90
- NEW 100
- NEW 120
- NEW 140
- NEW 150

- NEW M 16 x 30
- NEW 40
- NEW 50
- NEW 60
- NEW 70
- NEW 80
- NEW 90
- NEW 100
- NEW 120
- NEW 140
- NEW 150
- NEW 160
- NEW 180
- NEW 200

- NEW M 20 x 40
- NEW 50
- NEW 60
- NEW 70
- NEW 80
- NEW 90
- NEW 100
- NEW 120
- NEW 140
- NEW 150
- NEW 160
- NEW 180
- NEW 200