

SUPPORTI TIPO "G" – (Cuscinetto Ø 42 mm)

WALL AND SCREW-FIXING SUPPORTS TYPE "G"-(ball bearing Ø 42 mm)

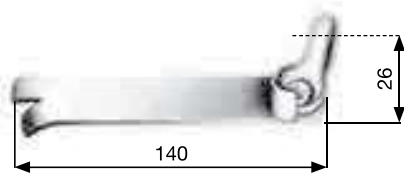

SUPPORTO A MURARE TIPO "G" WALL-FIXING SUPPORT TYPE "G"

133.S.14.20 Zincato – per cuscinetto Ø 42 mm
Galvanized – for ball bearing Ø 42 mm

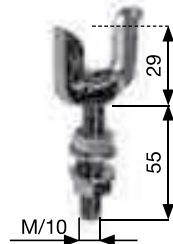

SUPPORTO REGISTRABILE CON VITE TIPO "G" ADJUSTABLE BEARING HOLDER TYPE "G"

146.P.00.20 Zincato – per cuscinetto Ø 42 mm
Galvanized – for ball bearing Ø 42 mm

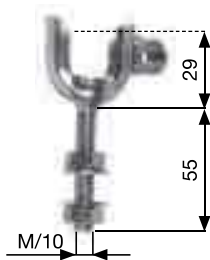

SUPPORTO REGISTRABILE CON VITE TIPO "G" PER RIDUTTORE ADJUSTABLE BEARING HOLDER "G" FOR REDUCTION PULLEY

146.P.RR.20 Zincato – per cuscinetto Ø 42 mm
Galvanized – for ball bearing Ø 42 mm

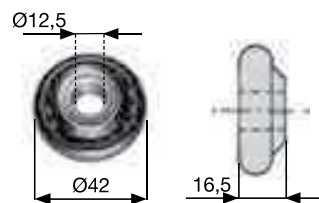

CUSCINETTO A SFERE TIPO "G" Ø 42 mm BALL BEARING TYPE "G" Ø 42 mm

145.C.FE.20 Zincato –boccola ferro, foro Ø12,5 mm
Galvanized – iron bush, hole Ø 12,5 mm

145.C.NY.20 Zincato –boccola nylon, foro Ø12,5 mm
Galvanized –nylon bush, hole Ø 12,5 mm

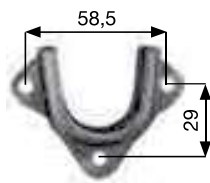

SUPPORTO A CASSONETTO TIPO "G" SCREW-FIXING SUPPORT TYPE "G"

150.S.00.20 Zincato – per cuscinetto Ø 42 mm
Galvanized – for ball bearing Ø 42 mm



SUPPORTO A CASSONETTO TIPO "G" CON FERMO PER RIDUTTORE SCREW-FIXING SUPPORT TYPE "G" WITH STOP FOR REDUCTION PULLEY

150.S.GR.20 Zincato – per cuscinetto Ø 42 mm
Galvanized – for ball bearing Ø 42 mm