

F490

CERNIERA F490:

LA SOLUZIONE INVISIBILE.

- Per ante in legno di spessore minimo 18 mm.
- Ideale per ante con telaio di alluminio di spessore contenuto.
- Apertura: 105°.
- Disponibile nella versione ammortizzata, non-ammortizzata o apertura libera.
- Possibilità di foratura anta: da 3 a 6 mm.
- Ammortizzatura escludibile (sistema brevettato Danco).
- Finiture: nera o nichel.
- Peso massimo anta: 16 kg.

F490 HINGE:

THE INVISIBLE SOLUTION.

- For wooden doors min. 18 mm thickness.
- Ideal solution for aluminum frame doors of minimal thickness.
- Opening angle: 105°.
- Available versions: soft closing, without soft closing or free opening.
- Door drilling possibility: from 3 to 6 mm.
- Excludable damper (Danco patented solution).
- Available finishing: black or nickel.
- Max. loading capacity: 16 kg.



■ LAVORAZIONI SU MOBILE IN LEGNO E ANTA IN LEGNO

■ WOODEN CABINET DRILLING AND WOODEN DOOR

BASE/CAPPELLO CABINET TOP/BOTTOM

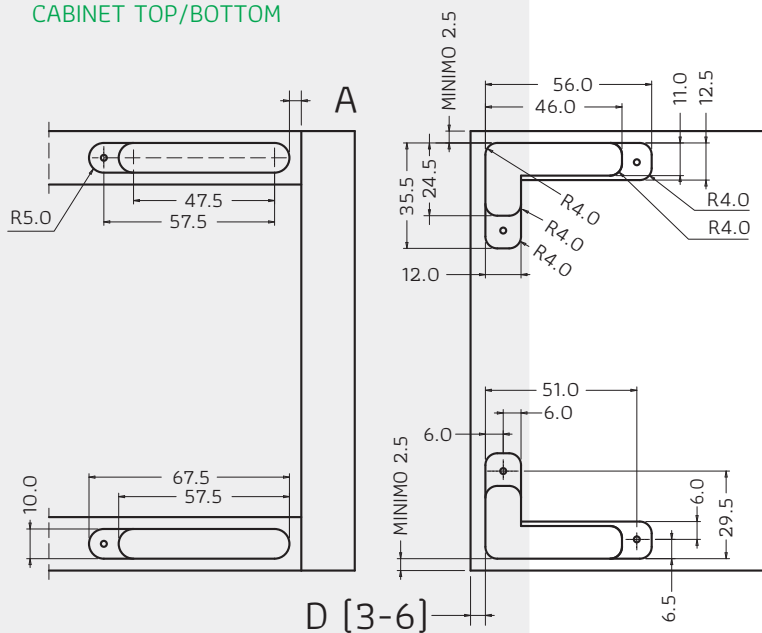

ANTA LEGNO WOOD DOOR

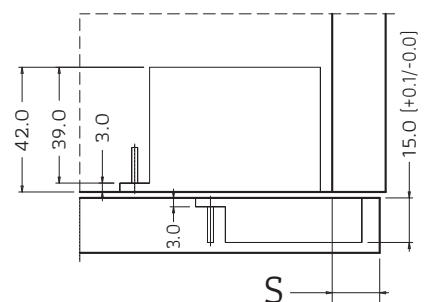

$$A = [17 + D] - S$$

■ ESEMPI DI APPLICAZIONE DELLA CERNIERA
■ HINGE APPLICATION EXAMPLES

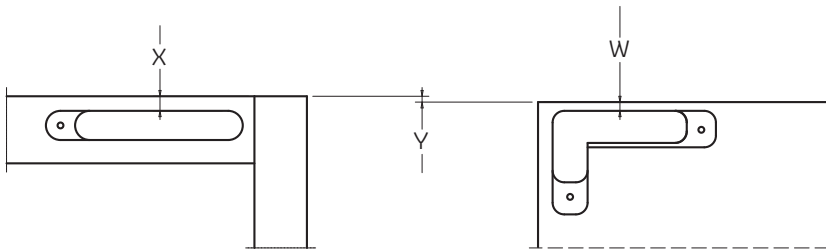
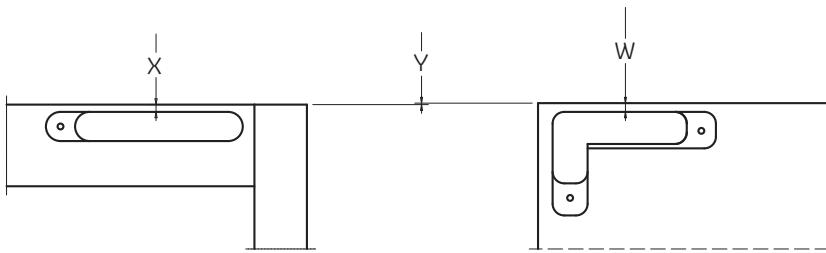
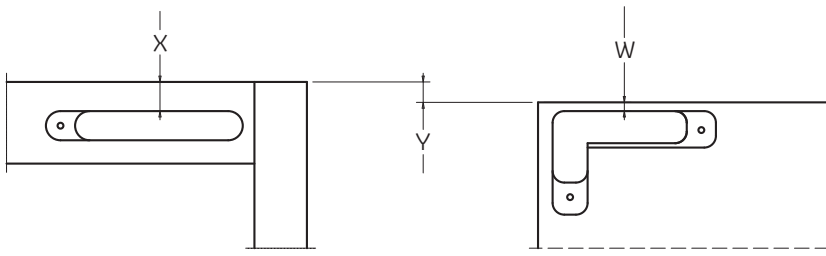

$V = [X - W]$

$W = [X - V]$

$X = [W + V]$



F490

- LAVORAZIONI SU MOBILE IN LEGNO E ANTA IN ALLUMINIO
- WOODEN CABINET DRILLING AND ALUMINIUM DOOR

BASE/CAPPELLO
CABINET TOP/BOTTOM

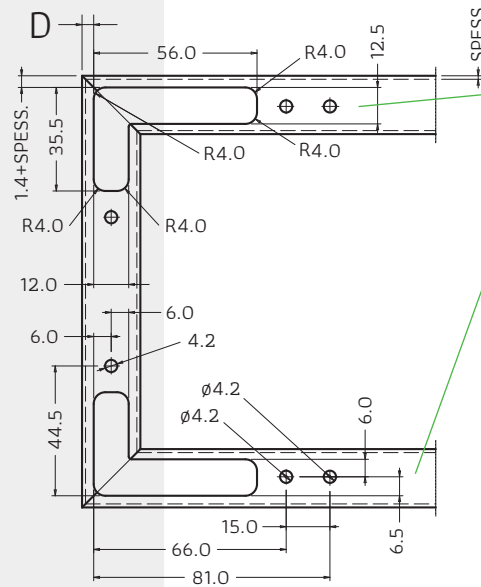
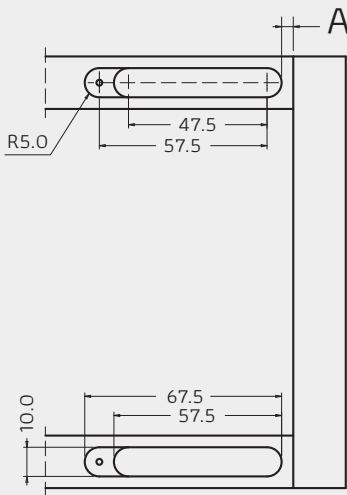

- SQUADRETTE DI FISSAGGIO [OPZIONALI]
- CORNER CONNECTORS [OPTIONAL]

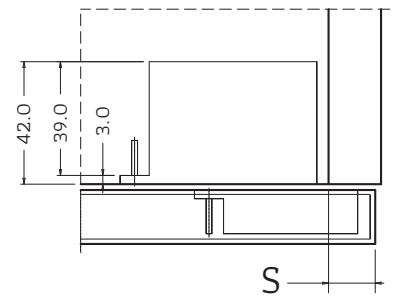

$$A = [17 + D] - S$$

$$D = 1.4 + \text{SPESS. ALLUM.}$$

