

Ø50 STAFFE TESTA STANDARD / BRACKETS STANDARD HEAD

Ø50 - DA VINCI ST / VOLTA SM - PS - PP - K7 / MARCONI ST - PS - K7

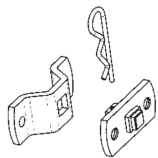
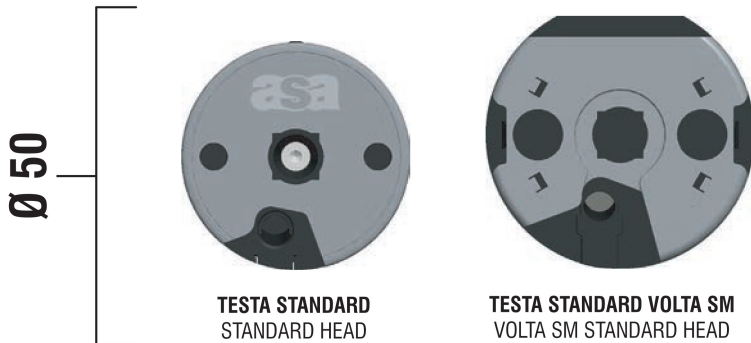

2204001

Staffa con perno quadrato completa di culla, interasse 48 mm e fori filettati
Bracket with square pin threaded holes with center-to-center distance 48 mm

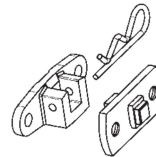

2204032

Staffa con perno quadrato con culla per innesto del perno "dall'alto" (solo per motori max 30 Nm)
Bracket with "open" housing for the square pin, clutch the pin from "above" (only for motors max 30 Nm)

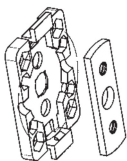

2204003

Staffa ad innesto "rapido", ridottissime dimensioni di ingombro e facile applicazione (solo per motori max 35 Nm)
Fast connection bracket minimum overall dimensions (only for motors max 35 Nm)

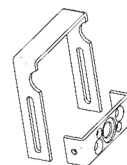

2204042

Staffa per mini cassonetti
Bracket for mini boxes
Length 137 mm

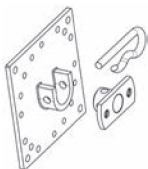

2204011

Staffa 100x100 con sella per perno rotondo a due posizioni
100x100 bracket with two positions round pin



NO VOLTA SM

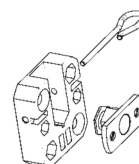

2204045

Staffa in zama con perno esagonale. L'inserimento del perno avviene "dall'alto"
Metal bracket with hexagonal pin clutch the pin from "above"

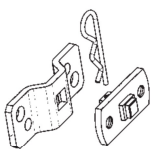

2204014

Staffa con perno quadrato completa di culla interasse 48/60 mm
Bracket with square pin center-to-center distance 48/60 mm

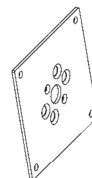

2204088

Staffa 100 x 100
100 x 100 bracket plate

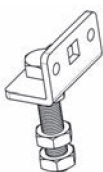

2204017

Staffa con perno Ø 10 per innesto diretto su murature già esistenti ideale nelle ristrutturazioni
Bracket Ø 10 threading pin for the direct clutch ideal for the existing clamp

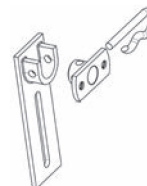

2204100

Staffa regolabile verticalmente con perno rotondo a due posizioni
Adjustable bracket with two positions round pin

NO VOLTA SM

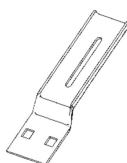

2204022

Staffa per supporti tipo "Torino" (aggiungere il perno quadrato per motori)
Bracket for support type "Torino" (match with square pin for motors)

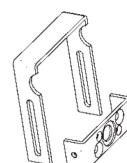

2204107

Staffa per mini cassonetti
Bracket for mini boxes
Length 90 mm

