

### Art. 61

Piastra di sospensione laterale rotante in acciaio per perno M12. Spessore porta minimo mm 40.

Steel rotating side suspension plate for M12 pin. Minimum door thickness mm 40.

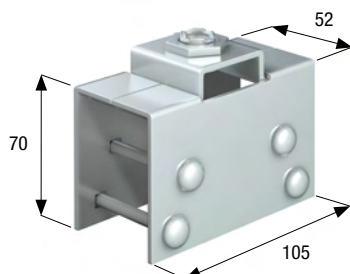

### Art. 60

GIREVOLE  
ROTATING

Piastra di sospensione rotante in acciaio con ganasce per perno M12. Spessore porta minimo mm 52.

Steel rotating clamp suspension plate for M12 pin. Minimum door thickness mm 52.

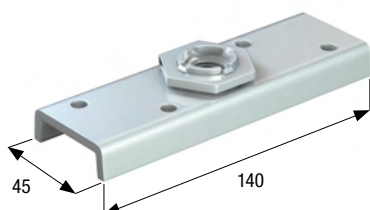

### Art. 1257

GIREVOLE  
ROTATING

Piastra di sospensione rotante in acciaio per perno M16. Spessore porta minimo mm 46.

Steel rotating suspension plate for M16 pin. Minimum door thickness mm 46.

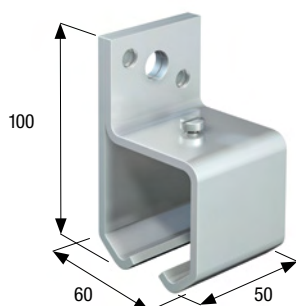

### Art. 1166

Staffa in acciaio per applicazione a parete del profilo superiore. Face fixing steel bracket for the upper track.

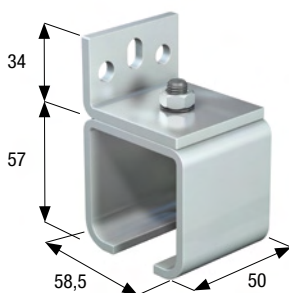

### Art. 59

Staffa in acciaio per applicazione a parete del profilo superiore. Face fixing steel bracket for the upper track.

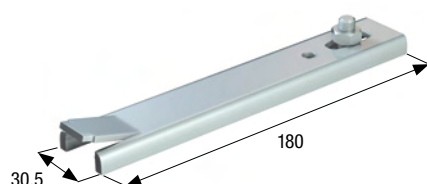

### Art. 56

Staffa a murare in acciaio per applicazione del profilo superiore. Wall fixing steel bracket for the upper track.

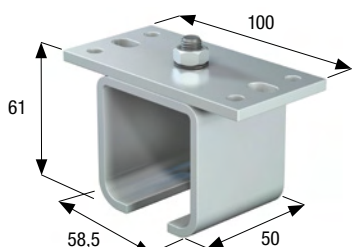

### Art. 58

Staffa in acciaio per applicazione a soffitto del profilo superiore. Ceiling fixing steel bracket for the upper track.