

Art. 10

25 kg
Portata massima
Carrying capacity

Profilo superiore in acciaio zincato con fori mm 4,5. Spessore mm 1.
Galvanized steel upper track with holes mm 4,5. Thickness mm 1.

Art. 8

Profilo in acciaio zincato senza fori | Galvanized steel track without holes

Misure standard | Standard lengths m 3 - m 4 - m 5 - m 6

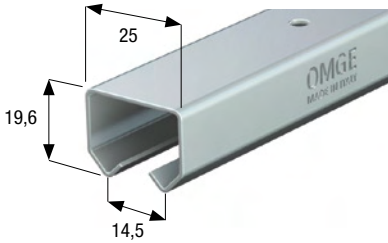

Art. 180

25 kg
Portata massima
Carrying capacity

Profilo in alluminio con fori mm 5. Spessore mm 1,5.
Natural aluminium upper track with holes mm 5. Thickness mm 1,5.

Misure standard | Standard lengths m 3 - m 4 - m 5 - m 6

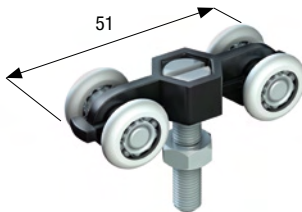

Art. 3

8 kg
Portata massima
Carrying capacity

**GIREVOLE
ROTATING**

Carrello regolabile in nylon con perno girevole M6 e ruote Ø mm 15 in delrin a completa corona di sfere.

Nylon adjustable roller with M6 turnable pin and Ø mm 15 ball bearing delrin wheels.



Art. 6 | 10 kg

Carrello con ruote in acciaio | Roller with steel wheels



Art. 1026 | 8 kg

Carrello con ruote in nylon | Roller with nylon wheels

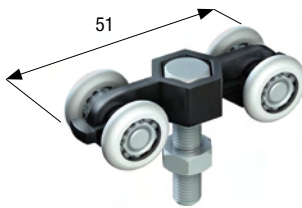

Art. 4

8 kg
Portata massima
Carrying capacity

Carrello regolabile in nylon con perno M6 e ruote Ø mm 15 in delrin a completa corona di sfere.

Nylon adjustable roller with M6 pin and Ø mm 15 ball bearing delrin wheels.



Art. 7 | 10 kg

Carrello con ruote in acciaio | Roller with steel wheels



Art. 1027 | 8 kg

Carrello con ruote in nylon | Roller with nylon wheels



Art. 125

8 kg
Portata massima
Carrying capacity

Carrello in acciaio con ruota Ø mm 15 in acciaio a completa corona di sfere.

Steel roller with Ø mm 15 ball bearing steel wheel.



Art. 1250 | 5 kg

Carrello con ruota in nylon | Roller with nylon wheel



Art. 1199 | 5 kg

Carrello con ruota in delrin | Roller with delrin wheel



Art. 16

8 kg
Portata massima
Carrying capacity

Carrello in acciaio con ruota Ø mm 15 in acciaio a completa corona di sfere.

Steel roller with Ø mm 15 ball bearing steel wheel.



Art. 19 | 5 kg

Carrello con ruota in nylon | Roller with nylon wheel



Art. 1176 | 5 kg

Carrello con ruota in delrin | Roller with delrin wheel