

Impugnatura in nylon per medaglia chiavi doppia mappa e chiavi a pompa serie 990***.

Code	Confezione singola	Confezione multipla	Min. ord.
990000	100	-	100

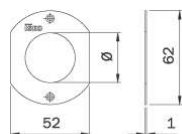

Ghiera piatta in ottone per cilindro a pompa, foro canotto antistrappo \varnothing mm 33.

990086	10	-	10
---------------	----	---	----

Ghiera piatta in **ottone nichelato** per cilindro a pompa, foro canotto antistrappo \varnothing mm 33.

990083	10	-	10
---------------	----	---	----

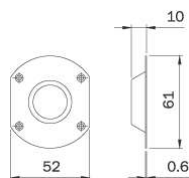

Ghiera concava in ottone per cilindro a pompa, foro cilindro \varnothing mm 27.

990090	10	-	10
---------------	----	---	----

Ghiera convessa in ottone per cilindro a pompa, foro cilindro \varnothing mm 27.

990090/C	10	-	10
-----------------	----	---	----

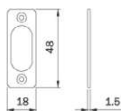

Ghiera foro cilindro ovale. In acciaio INOX. Per cilindri serie 83**.

042000	100	-	100
---------------	-----	---	-----

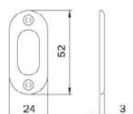

Ghiera foro cilindro ovale. In NYLON. Per cilindri serie 83**.

042001	100	-	100
---------------	-----	---	-----

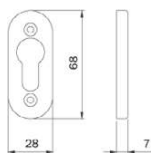

Ghiera foro cilindro profilo europeo. In alluminio ANODIZZATO ARGENTO.

042002	100	-	100
---------------	-----	---	-----

Ghiera foro cilindro profilo europeo. In alluminio ANODIZZATO ORO.

042003	100	-	100
---------------	-----	---	-----

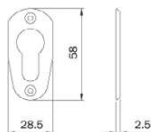

Ghiera foro cilindro profilo europeo. In OTTONE.

042027	100	-	100
---------------	-----	---	-----

Ghiera foro cilindro profilo europeo. In OTTONE NICHELATO.

042029	100	-	100
---------------	-----	---	-----

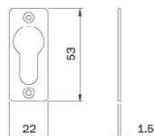

Ghiera foro cilindro profilo europeo. In acciaio INOX.

042030	100	-	100
---------------	-----	---	-----

Ghiera foro cilindro profilo europeo. In NYLON.

042040	100	-	100
---------------	-----	---	-----