

ISTRUZIONI DI MONTAGGIO

VIRTUS

by Bettio

2 BATTENTI CON VITI

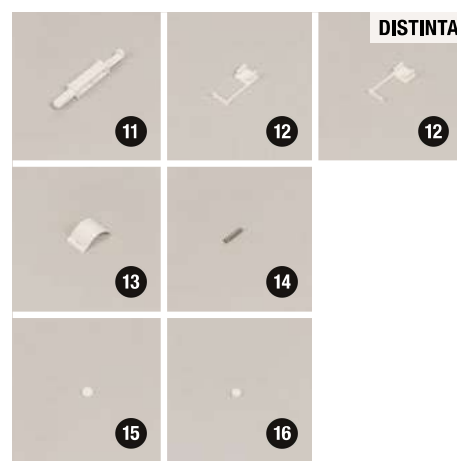
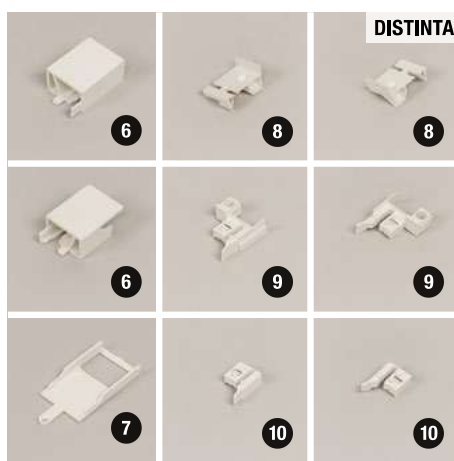
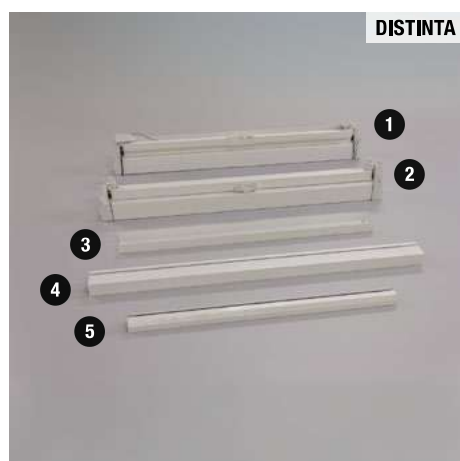

DISTINTA

1. Zanzariera semifissa
2. Zanzariera mobile
3. Compensatore superiore (x2)
4. Guida superiore (x2)
5. Guida inferiore (x2)
6. Prolunga sx-dx
7. Supporto cassonetto (x2)
8. Chiusura superiore sx-dx

DISTINTA

9. Copri scivolo sx-dx anta semifissa
10. Copri scivolo sx-dx anta mobile
11. Chiavistello
12. Copertura anti taglio sx-dx
13. Molletta di regolazione (x2)
14. Grano di regolazione guida superiore
15. Tappo vite
16. Tappo copertura vite Clic-clak®

ATTENZIONE

Non tutti gli accessori in plastica verranno utilizzati durante l'installazione.

In base al posizionamento delle ante, utilizzare solo uno tra i componenti 8, 9, 10 e 12.

FUORI SQUADRA

Nel caso in cui il vano abbia un fuori squadra orizzontale compreso tra 4 e 8 mm, consultare la sezione **Mollette di regolazione** prima di installare l'anta mobile.

ANTE VIRTUS

Virtus può essere installata indistintamente con apertura a sinistra o a destra, ma le ante non sono uguali: l'anta semifissa si blocca in posizione di lavoro e permette all'anta mobile di aprirsi e chiudersi. È quindi necessario valutare come orientare anta semifissa e anta mobile.

INSTALLAZIONE

Per installare correttamente Virtus iniziare dall'**anta semifissa (verde)** e proseguire con l'**anta mobile (blu)**. È fondamentale prestare attenzione al verso di installazione: l'anta mobile deve essere posizionata in corrispondenza del lato di apertura del serramento/passaggio.

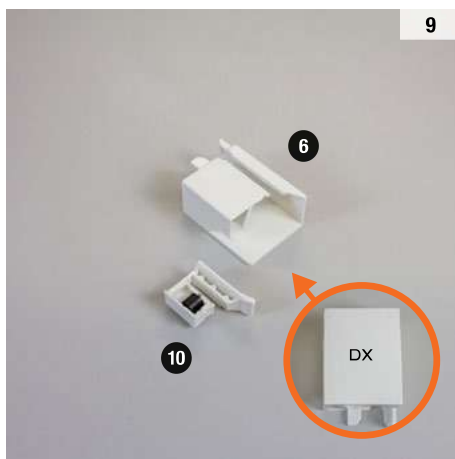
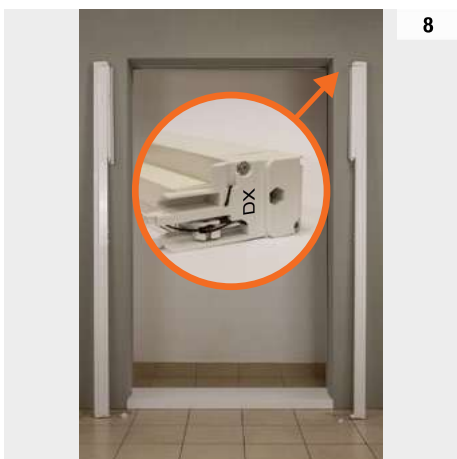
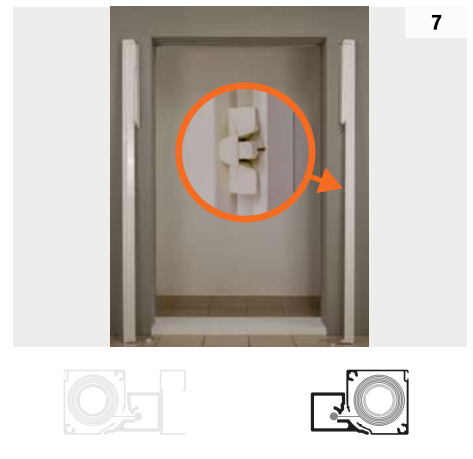
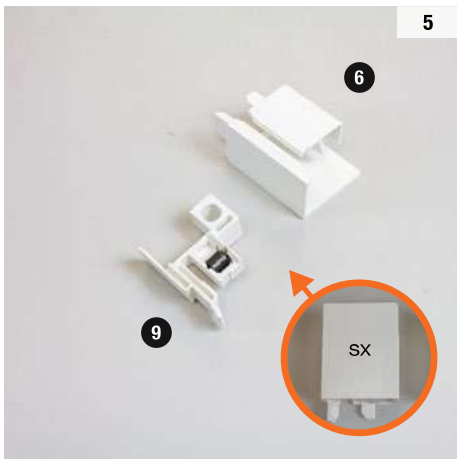
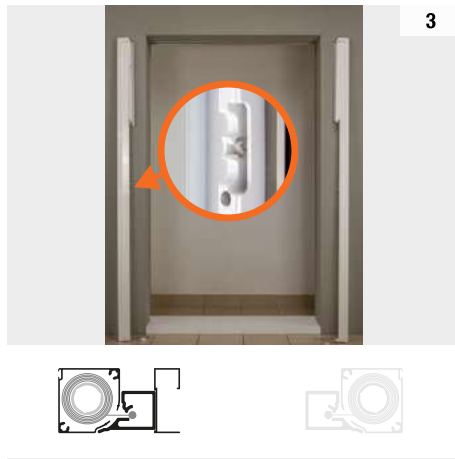
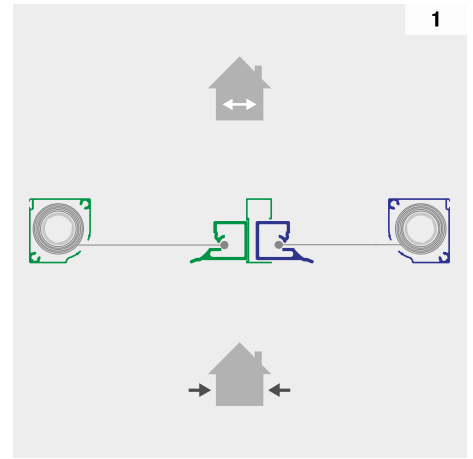

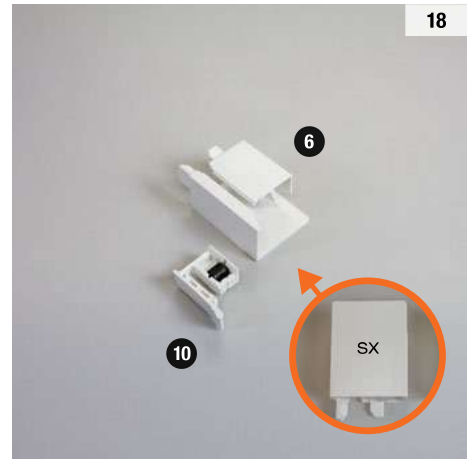
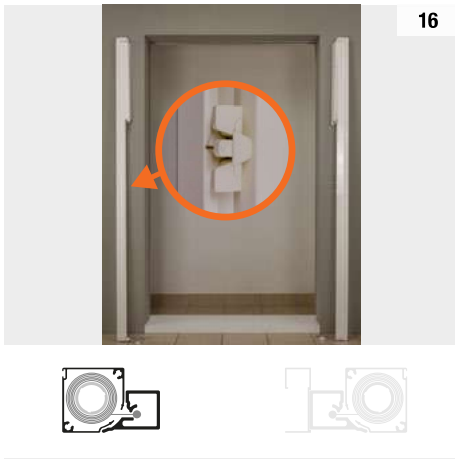
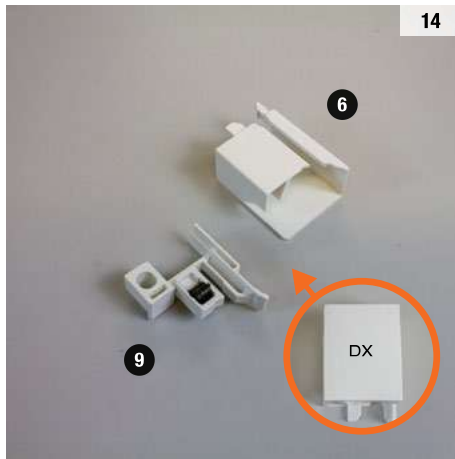
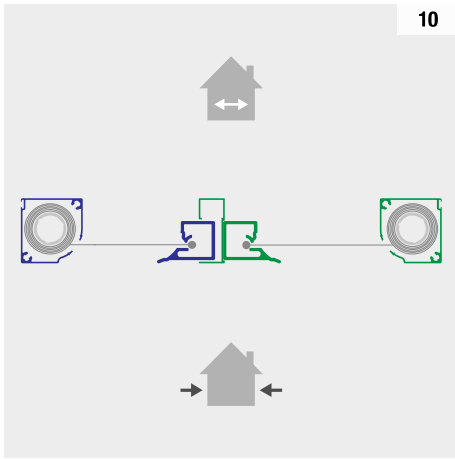

ANTA SEMIFISSA
INSTALLAZIONE
ACCESSORI

Consigliamo di eseguirla su un piano di lavoro o una superficie piana.

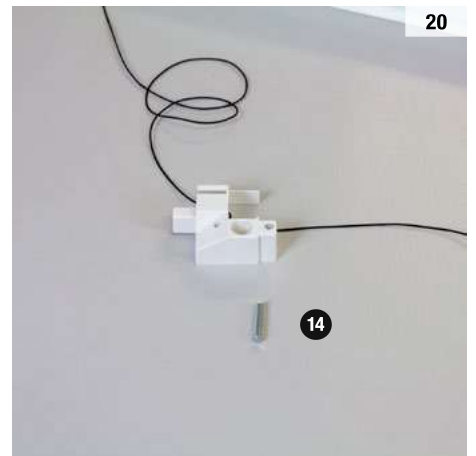

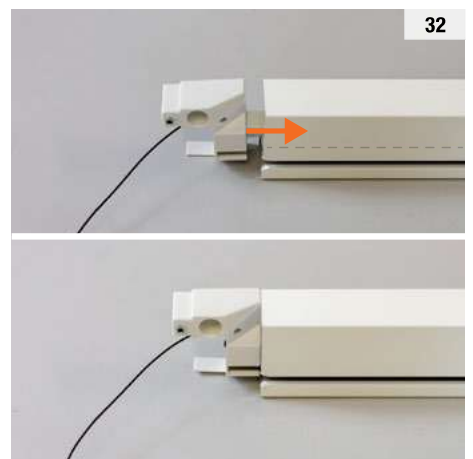
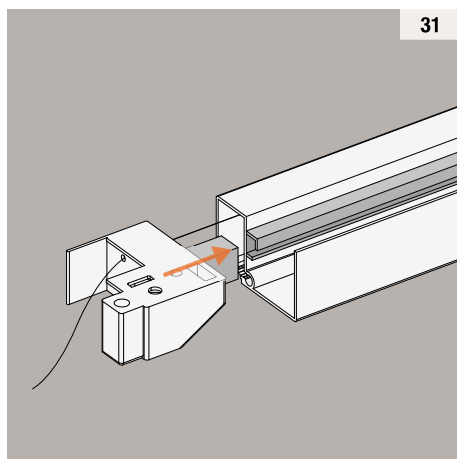
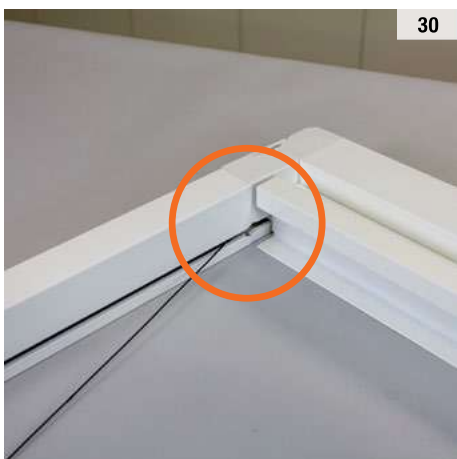
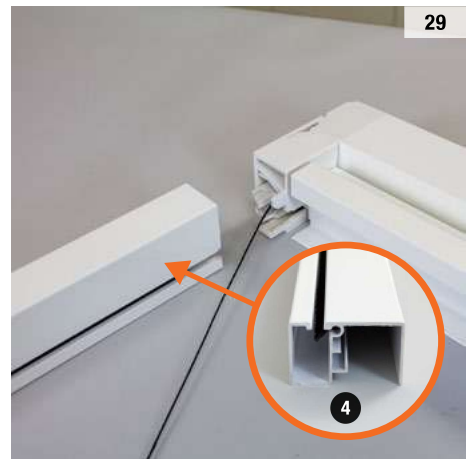
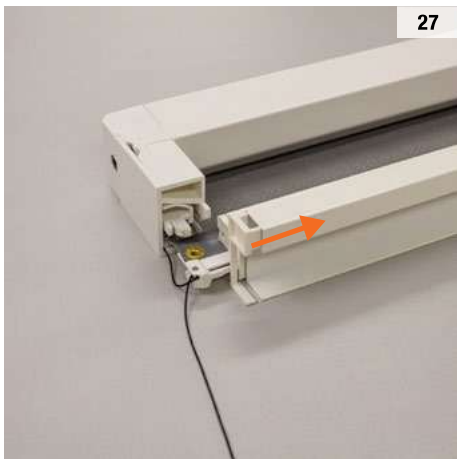
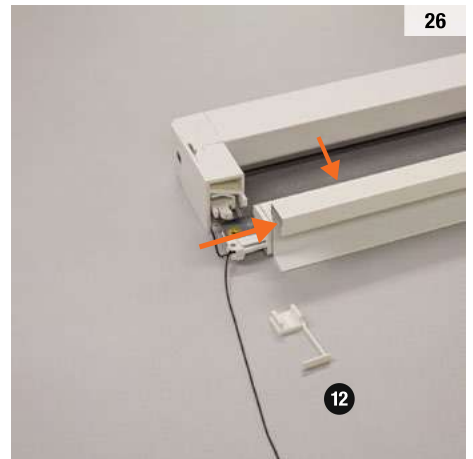
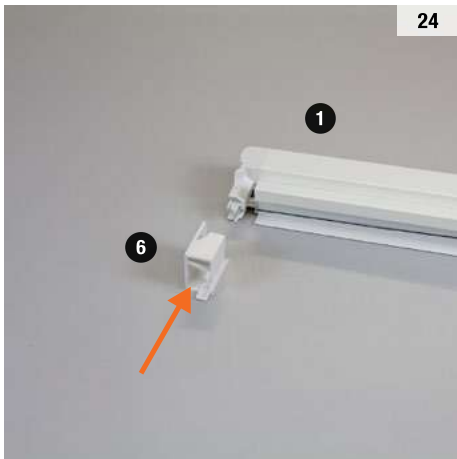
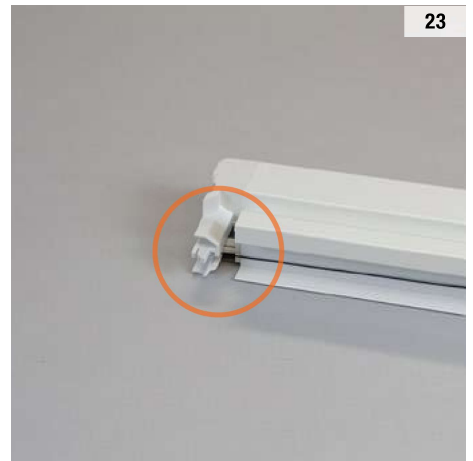
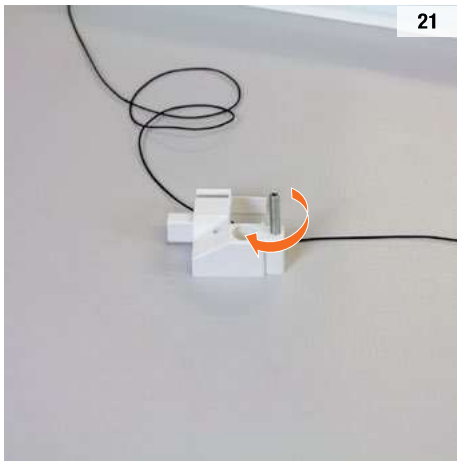

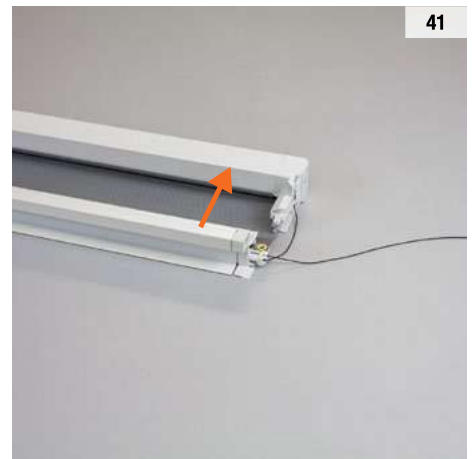
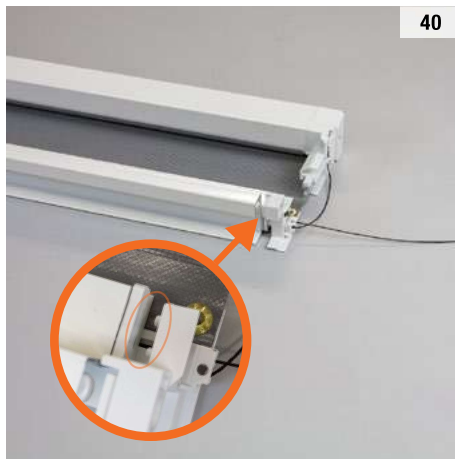
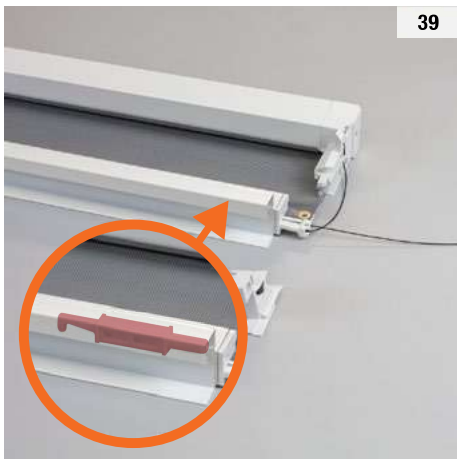
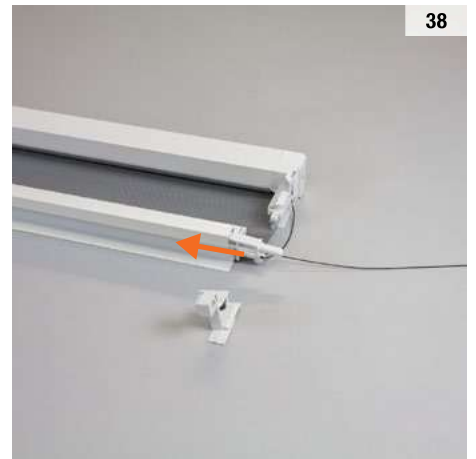
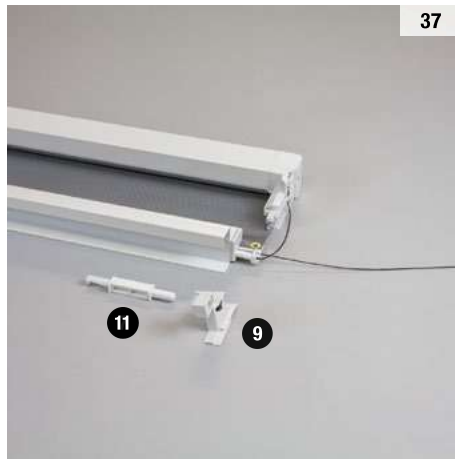
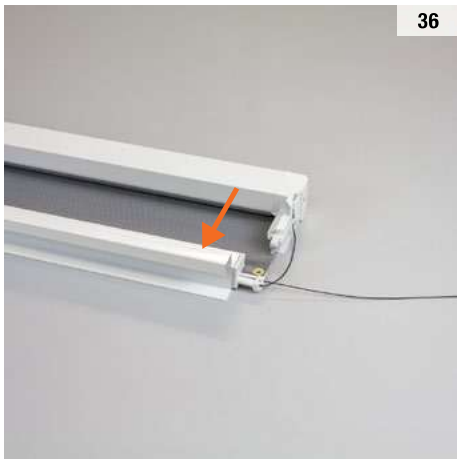

ANTA MOBILE
 INSTALLAZIONE
 ACCESSORI

Consigliamo di eseguirla su un piano
 di lavoro o una superficie piana.



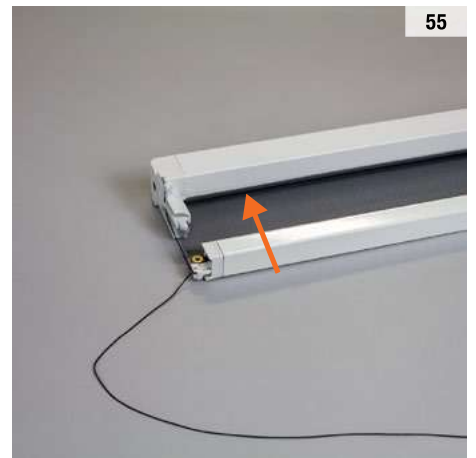
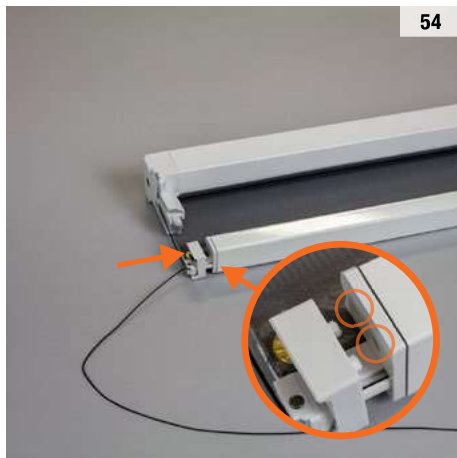
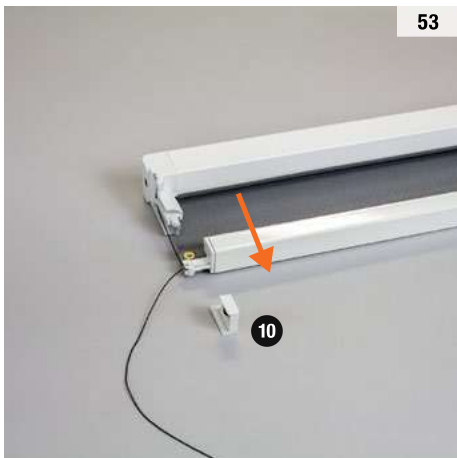
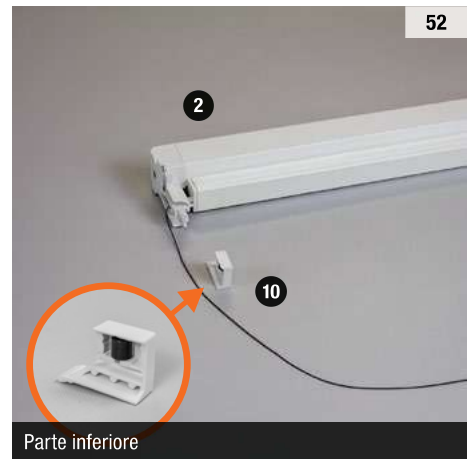
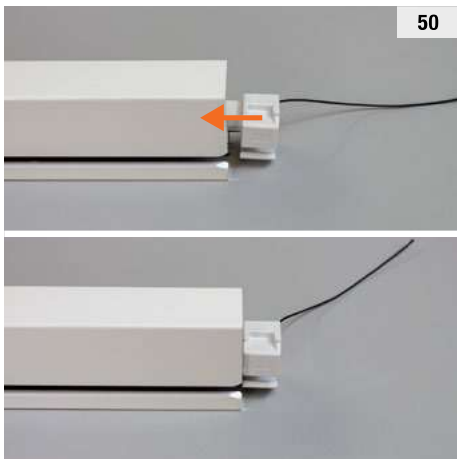
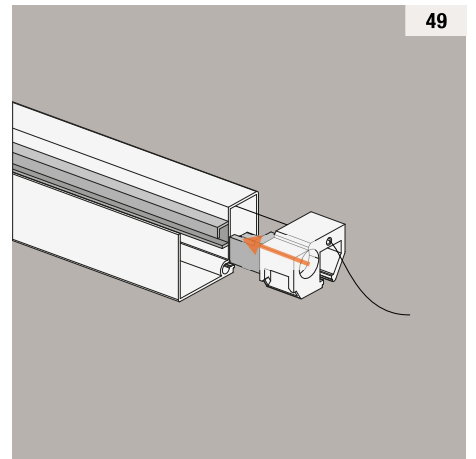
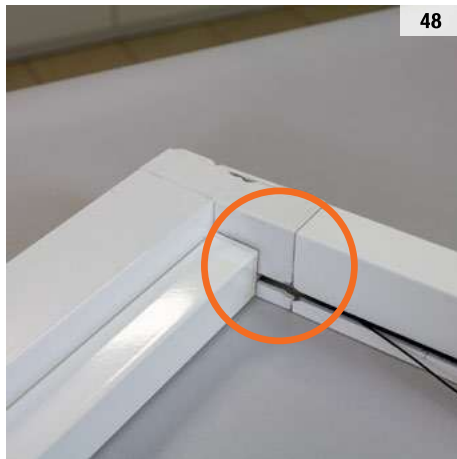
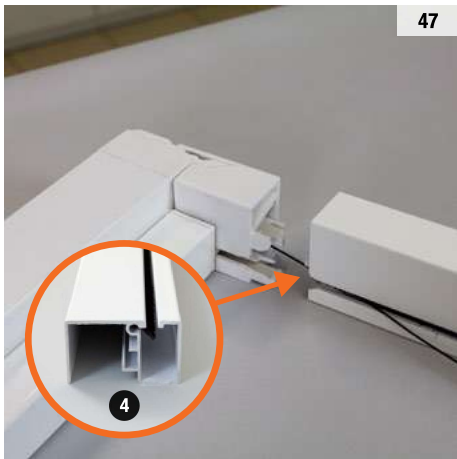
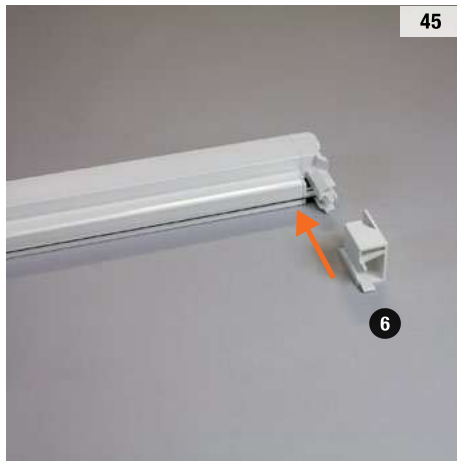
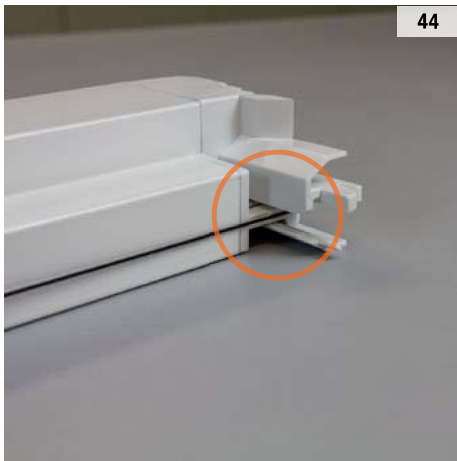



56

ATTENZIONE

In caso di fuori squadra orizzontale compreso tra 4 e 8 mm, consultare la sezione Mollette di regolazione

ANTA SEMIFISSA

INSTALLAZIONE

Installare sempre per prima



57



58

Installare il compensatore dell'anta semifissa appoggiandolo alla parete laterale.

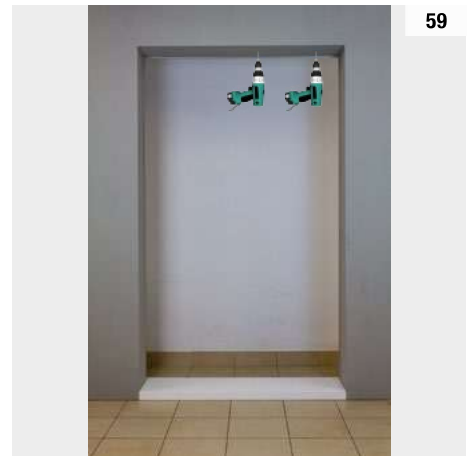

59



60



61



62

Allineare il compensatore dell'anta mobile a quello appena installato. Potrebbe rimanere aria tra la parete e il compensatore.

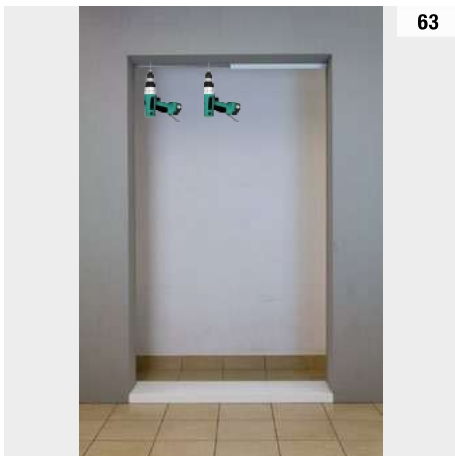

63

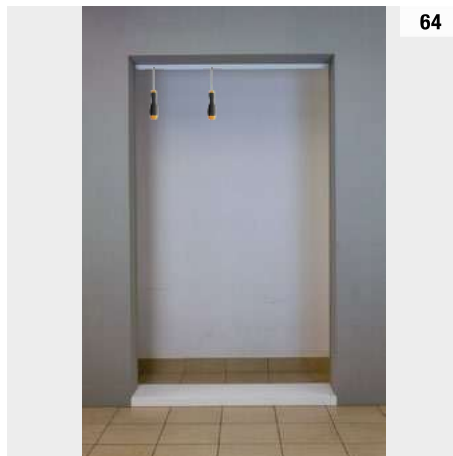

64



65



Installazione con biadesivo. Sgrassare e asciugare la superficie di fissaggio prima di incollare il biadesivo: la completa adesione si ottiene dopo almeno 24 ore. In alternativa procedere con l'installazione con viti.

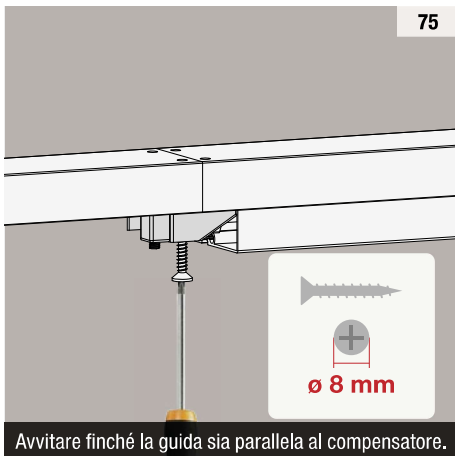
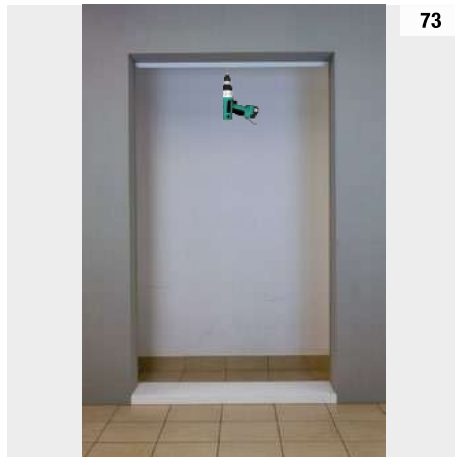
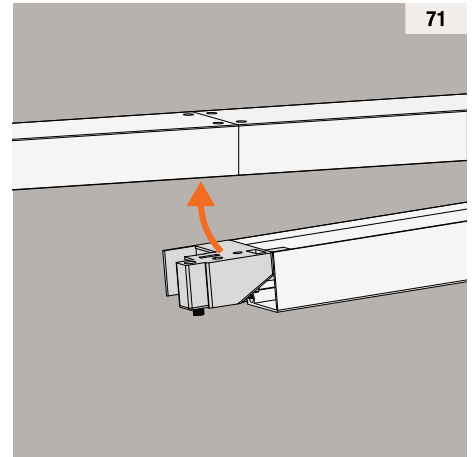

Avvitare finché la guida sia parallela al compensatore.

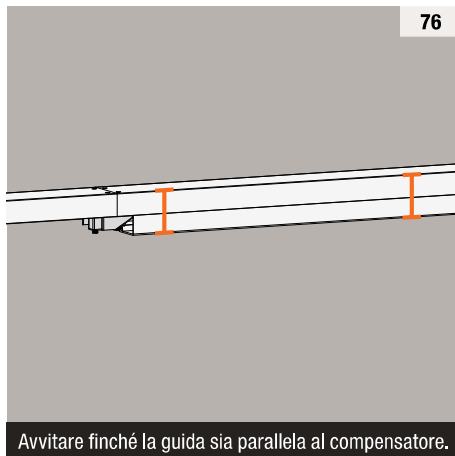

Avvitare finché la guida sia parallela al compensatore.

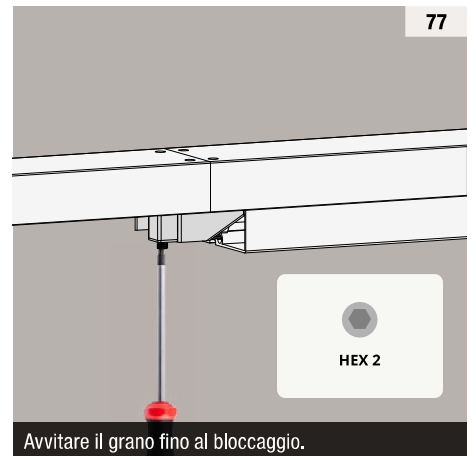

Avvitare il grano fino al bloccaggio.

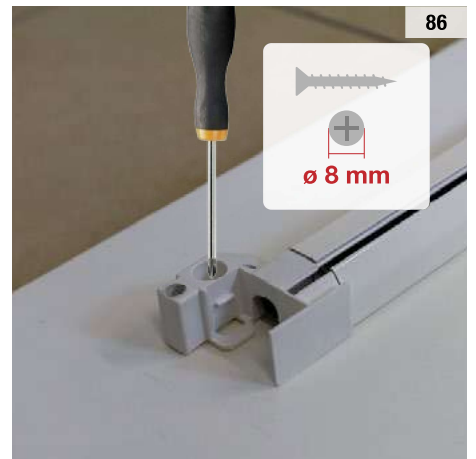
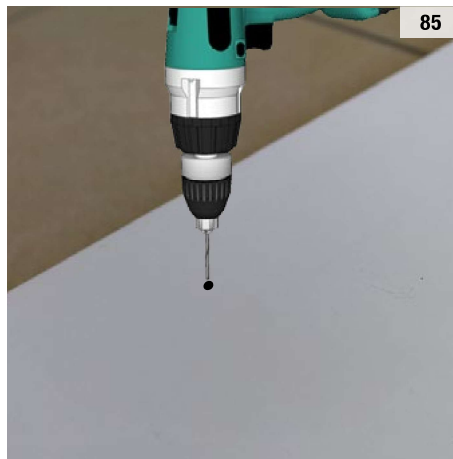
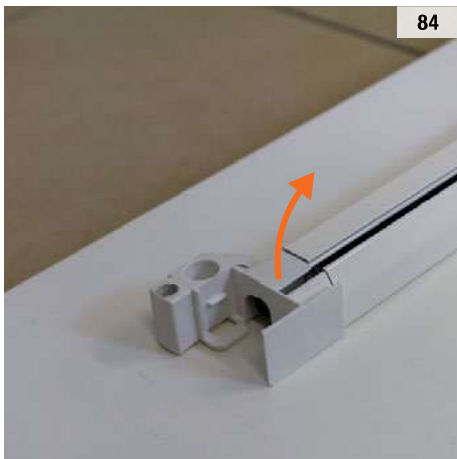
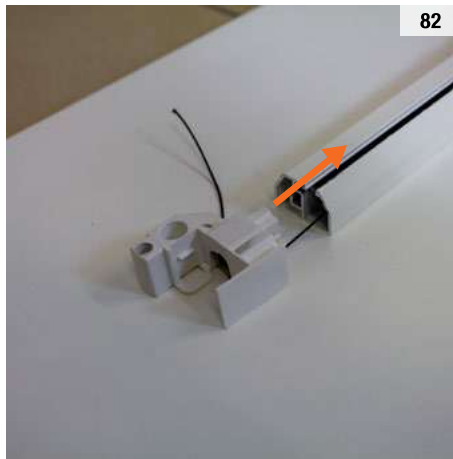

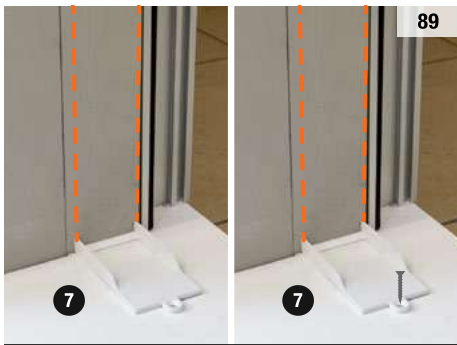

89

Installazione con biadesivo. Sgrassare e asciugare la superficie di fissaggio prima di incollare il biadesivo: la completa adesione si ottiene dopo almeno 24 ore. In alternativa procedere con l'installazione con viti.



90



91



92

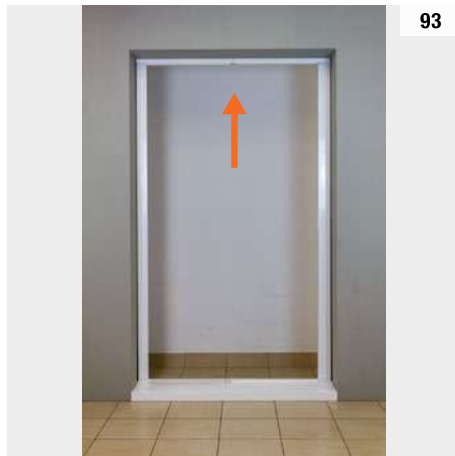

93



94



95



96

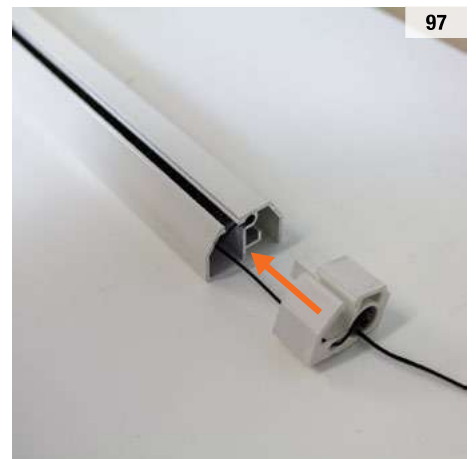

97



98



99



100

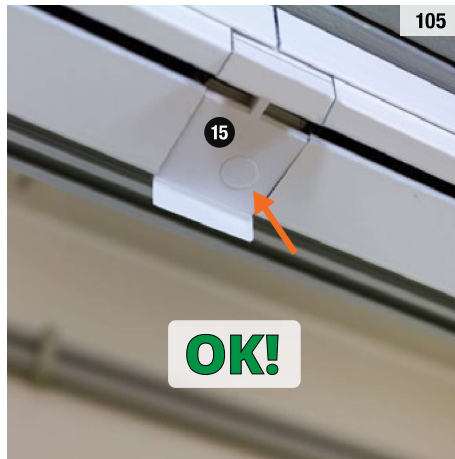
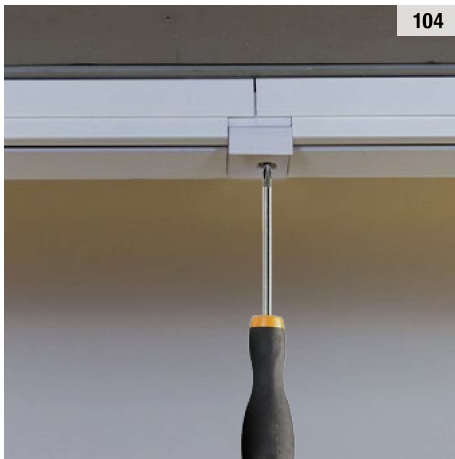
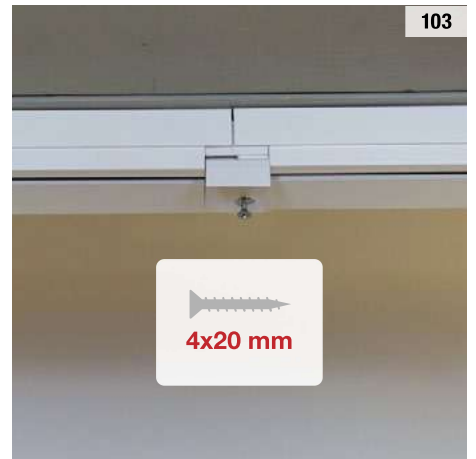

MOLLETTE DI REGOLAZIONE

Da montare sull'anta mobile solo in caso di fuori squadra orizzontale compreso tra 4 e 8 mm.

FUORI SQUADRA NELLA PARTE ALTA
Installare la molletta nella parte alta.

FUORI SQUADRA NELLA PARTE BASSA
Installare la molletta nella parte bassa.

ZANZARIERA STRETTA
Installare entrambe le mollette in alto e in basso.

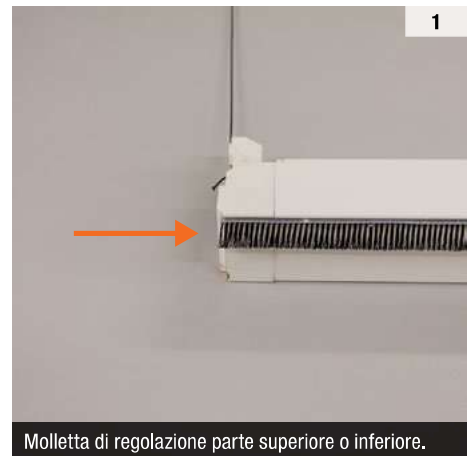

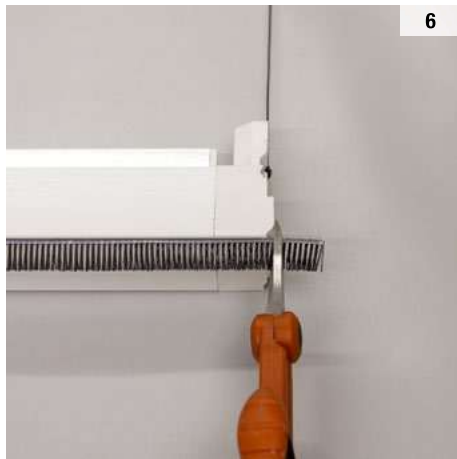
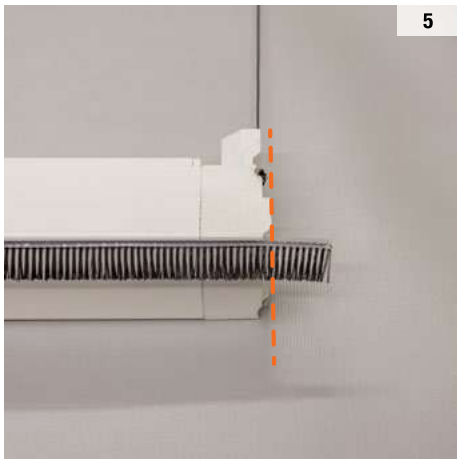
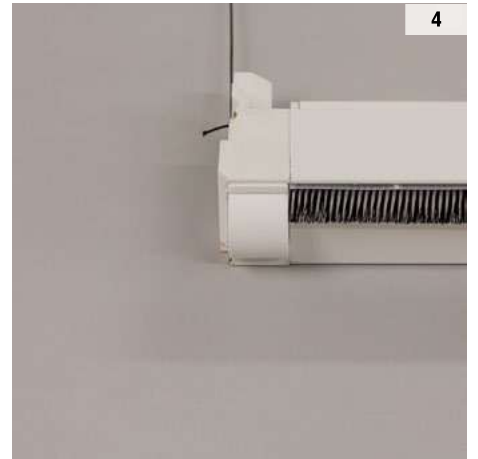
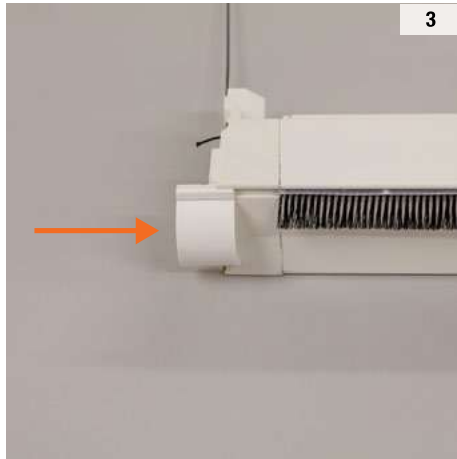
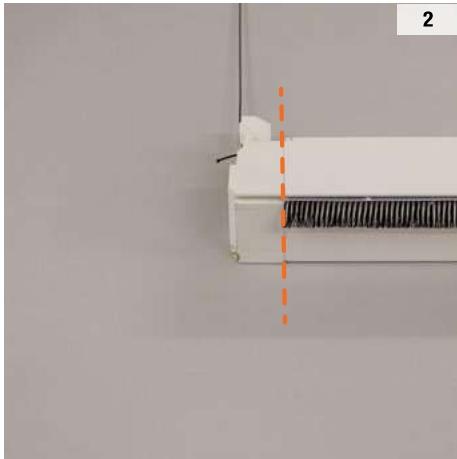

Molletta di regolazione sia nella parte superiore che in quella inferiore.

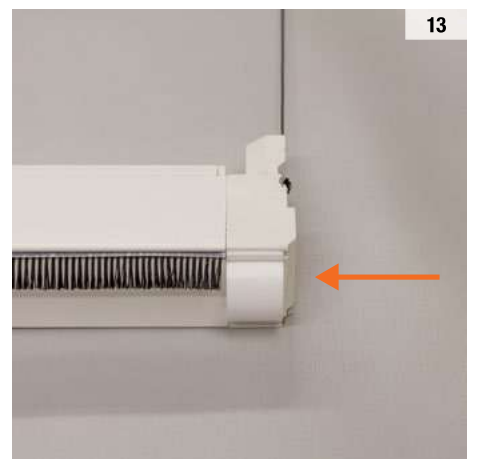
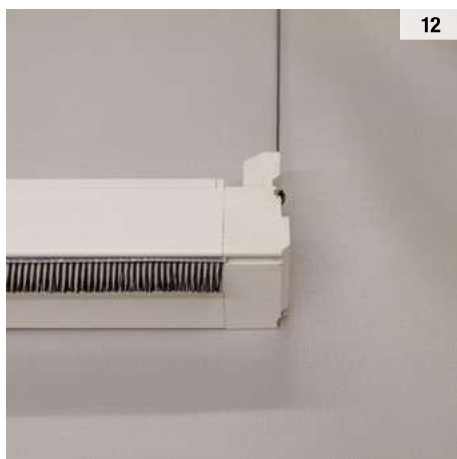
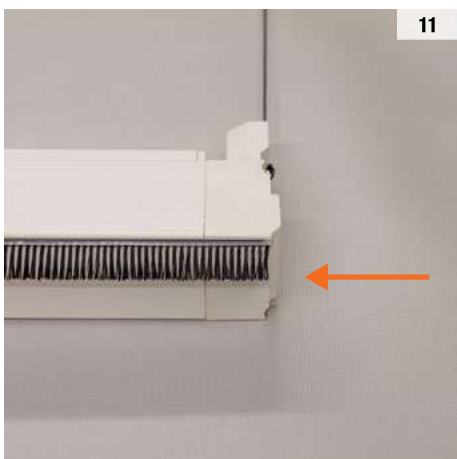
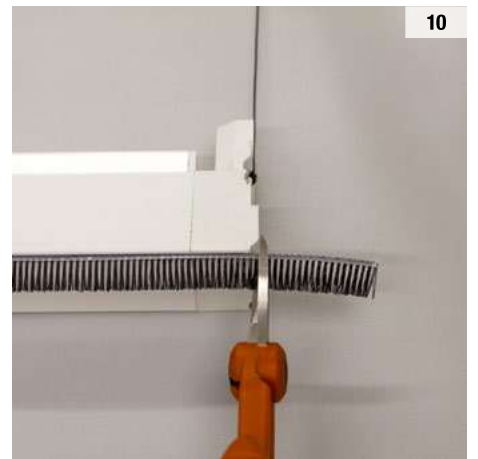
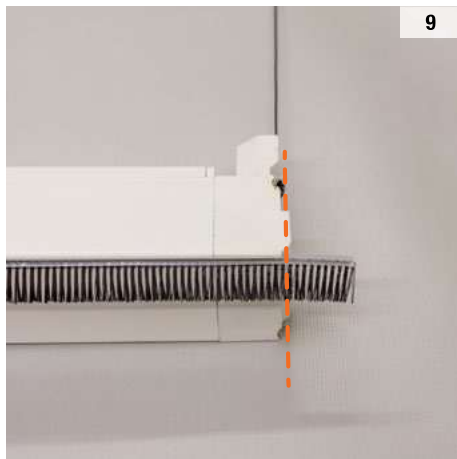



14

SISTEMA DI REGOLAZIONE MOLLA

Per zanzariere prodotte dall'1/12/2025

In caso Virtus faccia fatica a sganciare o sia troppo reattiva, è possibile regolare la molla.

1 giro in più o in meno modifica di molto la reattività della zanzariera.

Per la regolazione usare una chiave esagonale da 4 mm.



1

Il perno per sbloccare il sistema si trova sempre nella testata sinistra.

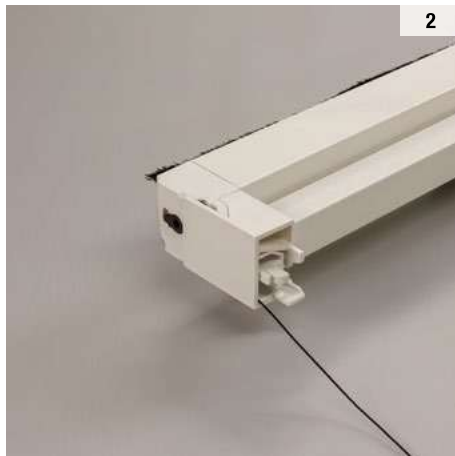

2

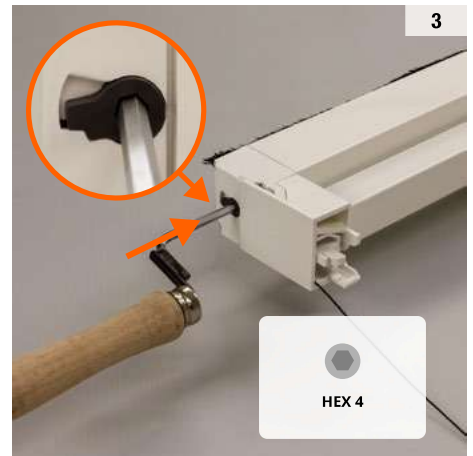

3

HEX 4

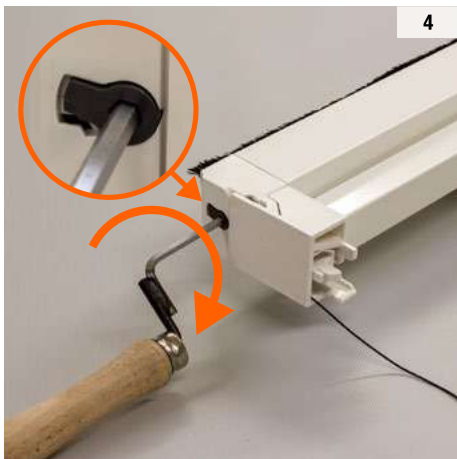

4

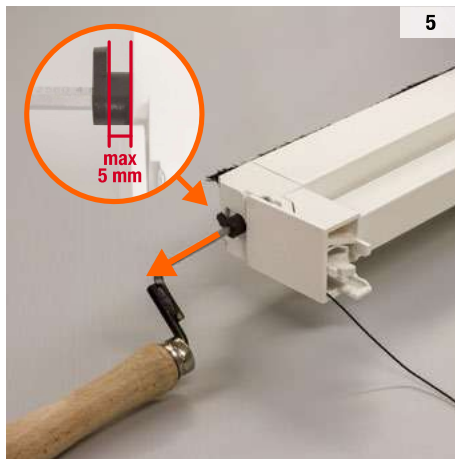

5

max 5 mm

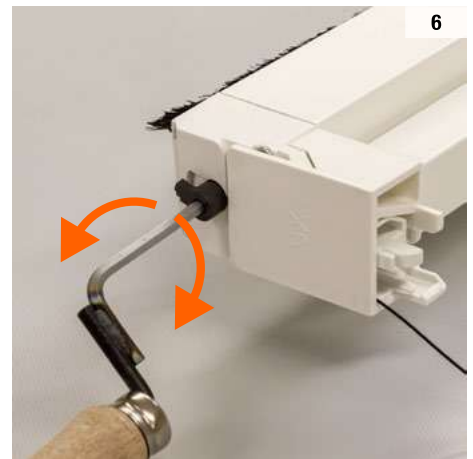

6

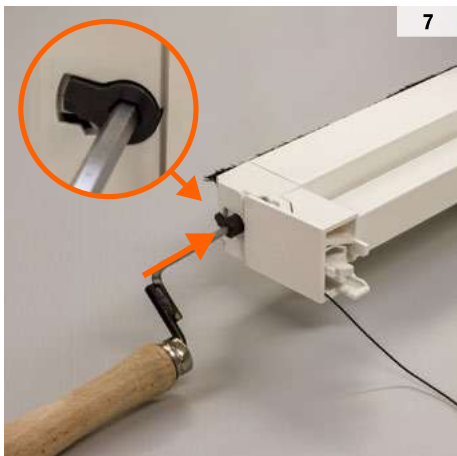

7

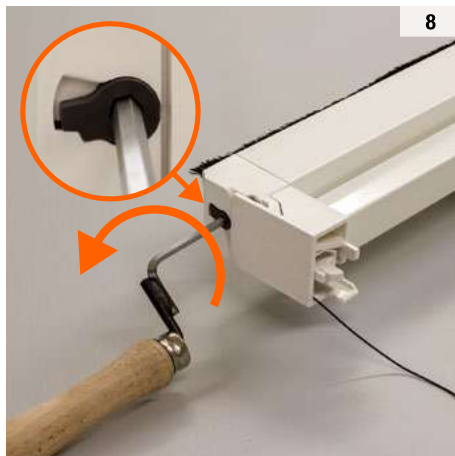

8



9

OK!

